

Bridging bars

Bridging bars are applied for convenient and safe connection of various groups: VA (MCBs), AD (RCBOs), VD (RCCBs) and VN (modular disconnectors). Buses with 18mm step are intended for commuting one-module-wide equipment; 27 mm step buses are designed for 1,5 module-fold wide devices. Buses are optimized per rated current of 100 A but can be used with rated current of 125 A if the incoming switch is connected on the center. There are plugs intended for 1,5 module wide buses.

Range

PIN 63 A

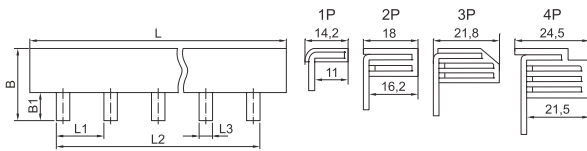

FORK 63 A

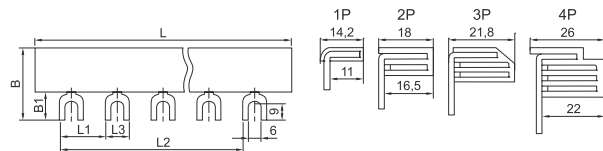

	Name	Rated current, A	Max. number of connected devices, pcs.	Dimensions, mm						Product ID
				L	L1	L2	L3	B	B1	
	PIN 1P 63 A 18 mm step IEK	63	53	1000	18	204	5,5	13,9	9,5	YNS21-1-063
	PIN 2P 63 A 18 mm step IEK	63	54	1000	18	193	5,5	20,2	11	YNS21-2-063
	PIN 3P 63 A 18 mm step IEK	63	54	1000	18	954	5,5	22,3	11,5	YNS21-3-063
	PIN 4P 63 A 18 mm step IEK	63	52	1000	18	918	5,5	28,3	12	YNS21-4-063
	PIN (12 pins) 1P 63 A 22cm	63	12	220	18	–	5,5	13,9	9,5	YNS21-1-063-22-12
	PIN (12 pins) 3P 63 A 22 cm	63	12	220	18	–	5,5	22,3	11,5	YNS21-3-063-22-12
	FORK 1P 63 A 18 mm step IEK	63	54	1000	18	954	11	15,4	11	YNS11-1-063
	FORK 2P 63 A 18 mm step IEK	63	54	1000	18	954	11	21,7	12,5	YNS11-2-063
	FORK 3P 63 A 18 mm step IEK	63	54	1000	18	954	11	22,8	11,5	YNS11-3-063
	FORK 4P 63 A 18 mm step IEK	63	52	1000	18	918	12	29,8	13,5	YNS11-4-063

PIN 100 A

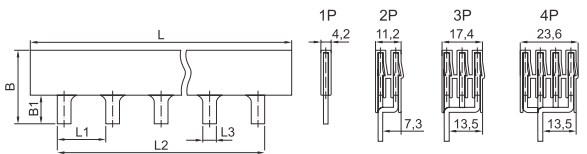

FORK 100 A

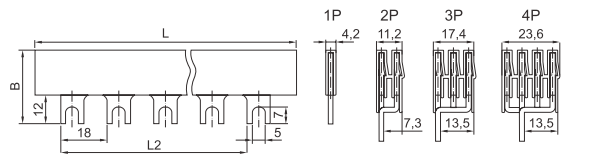

	Name	Rated current, A	Max. number of connected devices, pcs.	Dimensions, mm						Product ID
				L	L1	L2	L3	B	B1	
	PIN 1P 100 A 18 mm step IEK	100 (125*)	54	1000	18	954	5	30,5	12	YNS21-1-100
	PIN 2P 100 A 18 mm step IEK	100 (125*)	54	1000	18	954	5	37,5	12	YNS21-2-100
	PIN 3P 100 A 18 mm step IEK	100 (125*)	54	1000	18	954	5	37,5	12	YNS21-3-100
	PIN 4P 100 A 18 mm step IEK	100 (125*)	56	1030	18	990	6	37,5	12	YNS21-4-100
	PIN 1P 100 A 27 mm step IEK	100 (125*)	37	1000	27	972	7,5	38,5	20	YNS51-1-100
	PIN 2P 100 A 27 mm step IEK	100 (125*)	36	1000	27	945	7,5	46,2	12	YNS51-2-100
	PIN 3P 100 A 27 mm step IEK	100 (125*)	36	1000	27	945	7,5	46,2	12	YNS51-3-100
	PIN 4P 100 A 27 mm step IEK	100 (125*)	36	1030	27	945	7,5	46,2	12	YNS51-4-100
	FORK 1P 100 A 18 mm step IEK	100 (125*)	54	1000	18	954	9	30,5	12	YNS11-1-100
	FORK 2P 100 A 18 mm step IEK	100 (125*)	54	1000	18	954	9	37,5	12	YNS11-2-100
	FORK 3P 100 A 18 mm step IEK	100 (125*)	54	1000	18	954	9	37,5	12	YNS11-3-100
	FORK 4P 100 A 18 mm step IEK	100 (125*)	56	1030	18	990	9	37,5	12	YNS11-4-100
	Plug for PIN 1P 100 A 27 mm step IEK									YNK51-1-100
	Plug for PIN 2P 100 A 27 mm step IEK									YNK51-2-100
	Plug for PIN 3P 100 A 27 mm step IEK									YNK51-3-100
	Plug for PIN 4P 100 A 27 mm step IEK									YNK51-4-100

* It is possible to use buses for currents of 125A in case of center connection of the incoming switch.