







Prize incastabile cu CP





TRACON	I_n	U_n				a (mm)	b (mm)	c (mm)	d (mm)	e (mm)	f (mm)	g (mm)	IP..
				SCHUKO	FRENCH								
TICS-105S	16 A	250 V	2P + 	× 1	–	50	61	38	24	23	25	44	IP 44
TICS-105SF	16 A	250 V	2P + 	–	× 1	50	58	38	24	11	32	44	IP 44
TICS-105S67	16A	250V	2P+ 	×1	-	75	83	60	35	37	23	44	IP 67

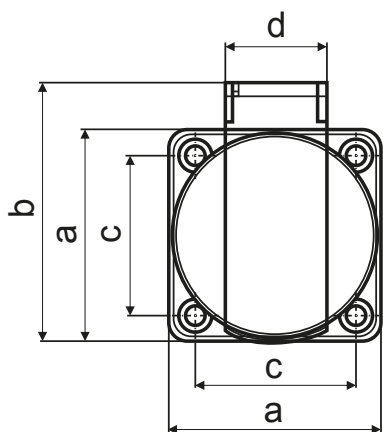
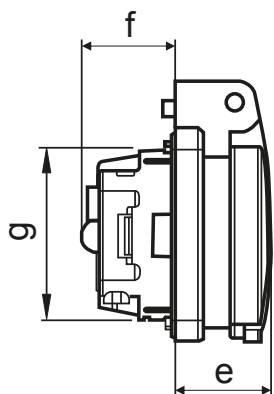

RELEVANT STANDARD
IEC 60884-1

RELEVANT STANDARD
MSZ 9871-2

Adaptoare cu contact de protecție lateral

TRACON	I_n	U_n	IN		OUT		D (mm)	L (mm)
								
			SCHUKO	CEE	SCHUKO	CEE		
TICS-A1	16 A	250 V	–	× 1	× 1	–	50	110
TICS-A3	16 A	250 V	× 1	–	–	× 1	73	84

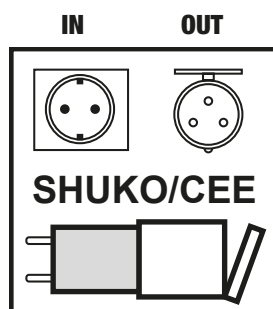
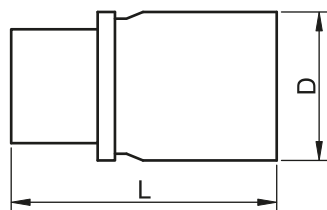
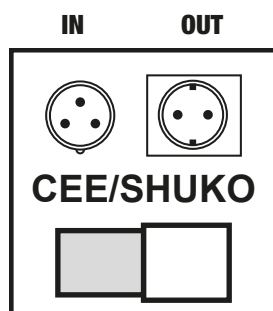

 Legendă
pictograme **G/O**

