

Butoane duble, pornit/oprit

I_e (AC 1, 230 V) 6 A	I_e (AC 15, 230 V) 3 A	I_e (DC 13, 230 V) 0,27 A	U_i 660 V	[mm²] 0,5-2,5	[mm²] x10 ⁶	F_{on} max. 20 N	T_a -25..+40°C	22 mm	Legendă pictograme	K/0
--	---	--	--------------------------------------	------------------------------------	---	------------------------------------	------------------------------------	--------------	---------------------------	------------



TRACON		IP 65	IP65	NC NO
NYG3-D				1×NO+1×NC
NYG3-D1	I	O		1×NO+1×NC
NYG3-D2	ON	OFF		1×NO+1×NC
NYG3-DL				1×NO+1×NC
NYG3-DL1	I	O		1×NO+1×NC
NYG3-DL2	ON	OFF		1×NO+1×NC

page K/32

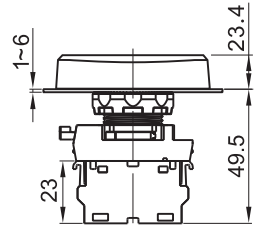

X1	X2	13	21
14	22	1NO	1NC

RELEVANT STANDARD EN 60947-1

RELEVANT STANDARD EN 60947-5-1

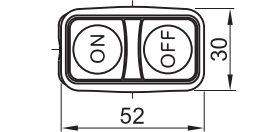

Comutatoare cu braț

I_e (AC 1, 230 V) 6 A	I_e (AC 15, 230 V) 3 A	I_e (DC 13, 230 V) 0,27 A	U_i 660 V	[mm²] 0,5-2,5	[mm²] 30×10 ⁴	T_a -25..+40°C	22 mm	Legendă pictograme	K/0
--	---	--	--------------------------------------	------------------------------------	---	------------------------------------	--------------	---------------------------	------------



TRACON		IP 65	IP65	NC NO
Normale	NYK3-S21BK			1×NO+1×NC
	NYK3-S31BK			2 × NO
	NYK3-S24BK			1×NO+1×NC
Revenire cu arc	NYK3-S32BK			2 × NO
	NYK3-S33BK			2 × NO
	NYK3-S34BK			2 × NO

page K/32

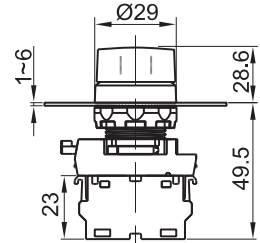

RELEVANT STANDARD EN 60947-1

RELEVANT STANDARD EN 60947-5-1

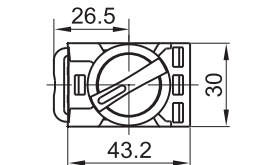

Normal, cu două poziții

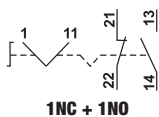

Normal, cu trei poziții

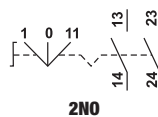

Două poziții, revenire cu arc

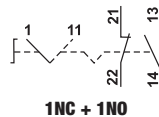

Trei poziții, revenire cu arc

