



GW 40 105

**DISTRIBUTION BOARDS WITH PANELS WITH WINDOW AND EXTRACTABLE FRAME  
PREDISPOSED FOR TERMINAL BLOCK - GREY RAL 7035**



Code	No. of modules EN 50022	Outer dim. LxHxD (mm)	Dispersible power (W)	Pack Carton
GW 40 104	24 (12x2)	298x420x140	32	3
GW 40 105	36 (12x3)	298x570x140	42	2
GW 40 107	36 (18x2)	410x463x140	43	2
GW 40 108	54 (18x3)	410x655x140	66	1
GW 40 109	72 (18x4)	410x878x160	89	1

**ACCESSORIES SUPPLIED:** screwcaps and module masks, circuit labels. Self-adhesive label to be filled out for certification according to standard CEI 23-51.

**NOTES:** dispersible power calculated according to CEI 23-49. For the perforations, use the GW52401 milling cutter.

To restore the double insulation, use the relative accessories supplied (module masks and screwcaps) or the brackets for surface-mounting (GW44621).

For applications in the photovoltaic environment, use the surface-mounting brackets - code GW44621.

**CHARACTERISTICS:** removable and plumbable panels with windows. Thermo-pressure with ball equal to 70°C.

**INSTALLATION:** for the possible enclosure-terminal block combinations, refer to the summary "COMPATIBILITY OF SURFACE-MOUNTING ENCLOSURES WITH BIPOLAR AND UNIPOLAR TERMINAL BLOCKS" in the selection guides of 40CD range.



GW 40 105 BD

**DISTRIBUTION BOARDS WITH WINDOWED REMOVABLE PANELS, EXTRACTABLE FRAME  
EQUIPPED WITH 80 A IP20 BIPOLAR SCREW TERMINAL BLOCKS - GREY RAL 7035**



Code	No. of modules EN 50022	Outer dim. LxHxD (mm)	Dispersible power (W)	Pole 1 (mm <sup>2</sup> )	Pole 2 (mm <sup>2</sup> )	Pack Carton
GW 40 104 BS	24 (12x2)	298x420x140	32	N/E (3x16) + (11x10)	N/E (3x16) + (11x10)	3
GW 40 104 BD	24 (12x2)	298x420x140	32	N/E 2x[(3x16) + (11x10)]	N/E 2x[(3x16) + (11x10)]	3
GW 40 105 BD	36 (12x3)	298x570x140	42	N/E 2x[(3x16) + (11x10)]	N/E 2x[(3x16) + (11x10)]	2
GW 40 105 UD	36 (12x3)	298x570x140	42	N/E (3x16) + (29x10)	N/E (3x16) + (29x10)	2
GW 40 107 BS	36 (18x2)	410x463x140	43	N/E (3x16) + (17x10)	N/E (3x16) + (17x10)	2
GW 40 107 BD	36 (18x2)	410x463x140	43	N/E 2x[(3x16) + (17x10)]	N/E 2x[(3x16) + (17x10)]	2
GW 40 108 BD	54 (18x3)	410x655x140	66	N/E 2x[(3x16) + (17x10)]	N/E 2x[(3x16) + (17x10)]	1
GW 40 108 BT	54 (18x3)	410x655x140	66	N/E 3x[(3x16) + (17x10)]	N/E 3x[(3x16) + (17x10)]	1
GW 40 109 BD	72 (18x4)	410x878x160	89	N/E 2x[(3x16) + (17x10)]	N/E 2x[(3x16) + (17x10)]	1
GW 40 109 BQ	72 (18x4)	410x878x160	89	N/E 4x[(3x16) + (17x10)]	N/E 4x[(3x16) + (17x10)]	1

**ACCESSORIES SUPPLIED:** screwcaps and module masks, circuit labels. Self-adhesive label to be filled out for certification according to standard CEI 23-51. Insulated bipolar screw 80A - IP20 terminal blocks to be installed on the frame before wiring.

**NOTES:** dispersible power calculated according to CEI 23-49. For the perforations, use the GW52401 milling cutter. To restore the double insulation, use the relative accessories supplied (module masks and screwcaps) or the brackets for surface-mounting (GW44621). For applications in the photovoltaic environment, use the surface-mounting brackets - code GW44621.

**CHARACTERISTICS:** thermo-pressure with ball equal to 70°C.

**DISTRIBUTION BOARDS**

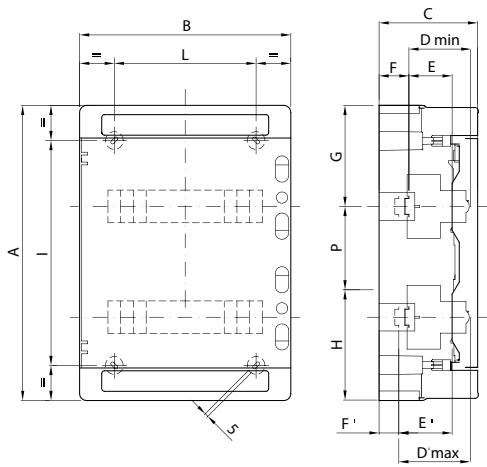

	Code	Overall dimensions			Modular assembly								Fixing			
		A	B	C	D min	E	F	G	H	P	D'max	E'	F'	NR	I	L
24M	GW 40 104	420	298	140	75	48	48	147.5	122.5	150	102	75	21	4	320	200
	GW 40 104 BS															
	GW 40 104 BD															
36M	GW 40 105	570	298	140	75	48	48	147.5	122.5	150	102	75	21	4	494	200
	GW 40 105 BD															
	GW 40 105 UD															
	GW40107															
	GW40107BS															
GW40107BD																
54M	GW 40 108	655	410	140	75	48	48	162.5	142.5	175	102	75	21	6	293	319
	GW 40 108 BD															
72M	GW 40 109	878	410	160	75	48	48	175	155	200 175	102	75	21	6	394	319
	GW 40 109 BD															
	GW 40 109 BQ															