

FLUSH-MOUNTING BOXES FOR MASONRY WALLS

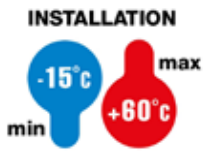

GWT
650°C



RECTANGULAR BOXES - BIG BOX



GW 24 403

BIG BOX HIGH CAPACITY RECTANGULAR BOXES FOR DOMESTIC, MODULAR AND DOMOTICS RANGES



Code	Description	Fixing supports axles distance	Compartment pre-arrangement	Outer dim. LxHxD (mm)	Pack Carton
GW 24 403	3 gang	83.5 mm	3	119x80x50	15/345
GW 24 404	4 gang	108.5 mm	4	144x85x50	5/135
GW 24 406	6 gang	100 mm	6	194x90x50	3/36
GW 24 206	6 gang (3+3)	83.5 mm	1	108x124x50	5/150
GW 24 237	8 gang (4+4)	108.5 mm	2	131x129x53	2/24
GW 24 238	12 gang (6+6)	163.5 mm	2	186x132x53	2/24
GW 24 239	18 gang (6+6+6)	163.5 mm	3	186x190x65	2/16

CHARACTERISTICS: GW24403, GW24404 and GW24406 can be combined with a reusable, mortar-proof, protective shield; functional dividers and joint elements. GW24206: suitable for assembly of GW24005 self-supporting "Compact" plates and GW24215 - GW24216 blank "Compact" plates.

ACCESSORIES SUPPLIED: GW24237, GW24238 and GW24239 include functional dividers.

APPLICATIONS: ideal for use in the Home6Building Automation.

NOTES: GW24239 for PLAYBUS range only.



GW 24 403 P

MORTAR-PROOF PROTECTIVE SHIELDS FOR BIG BOX RECTANGULAR BOXES



Code	For BIG BOX boxes	Pack Carton
GW 24 403 P	GW24403	200
GW 24 404 P	GW24404	50
GW 24 406 P	GW24406	50

CHARACTERISTICS: in technopolymer. Total protection during brick wall work, painting and finishing operations.

Equipped with soft technopolymer antennas for identification purposes, and a central handle making it easier to pull it out.

NOTES: clip fixing to speed up assembly and removal operations.



GW 24 321

FUNCTIONAL DIVIDER FOR RECTANGULAR BOXES

Code	For BIG BOX boxes	For GREEN WALL boxes	Pack Carton
GW 24 321	GW24403, GW24404, GW24406	GW24403PM, GW24404PM, GW24406PM	200

APPLICATIONS: to separate circuits of different voltages in accordance with Systems Standard IEC 60364 (international) and HD 384 (european).

FLUSH-MOUNTING BOXES FOR MASONRY WALLS

TECHNICAL CHARACTERISTICS

Standard: IEC 60670-1; EN 60670-1;

Degree of protection: IP40

Installation temperature: max. +60°C; min. -15°C

Material: GW PLAST technopolymer, halogen-free in accordance with EN 60754-2 (CEI EN 50267-2-2)

Impact resistance: IK 07

Heat resistance: thermo-pressure with ball 70°C

Resistance to abnormal heat and fire: Glow wire test 650°C

Installation: for masonry walls

BEHAVIOUR WITH CHEMICAL AND ATMOSPHERIC AGENTS

Saline solution	Acids		Bases		Solvents				Mineral oil	UV rays
	Concentrated	Diluted	Concentrated	Diluted	Hexane	Benzol	Acetone	Ethyl alcohol		
Resistant	Not resistant	Not resistant	Limited resistance	Limited resistance	Not resistant	Not resistant	Not resistant	Limited resistance	Limited resistance	Limited resistance

Dimension tables

FLUSH-MOUNTING BOXES

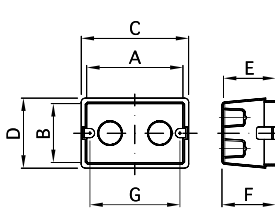

3 gang GW 24 403
4 gang GW 24 404

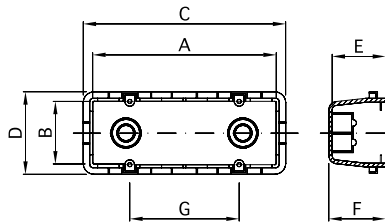

6 gang GW 24 406

Code	GW 24 403	GW 24 404	GW 24 406
	3 gang BIG BOX	4 gang BIG BOX	6 gang BIG BOX
A	96	121	171
B	58	58	60
C	119	144	194
D	80	85	90
E	49	49	49
F	50.5	50.5	50.5
G	83.5	108.5	100

6 gang GW 24 206

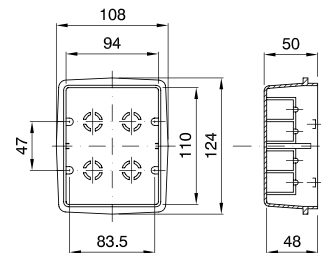

8 gang GW 24 237

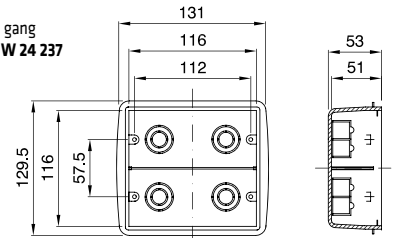

12 gang GW 24 238

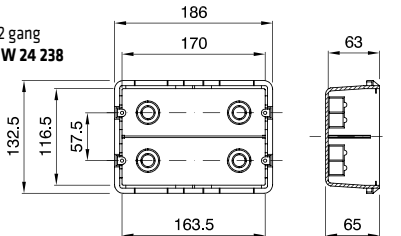

18 gang GW 24 239

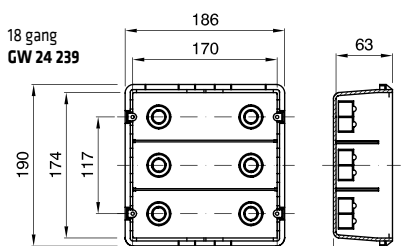

ROUND GW 24 232

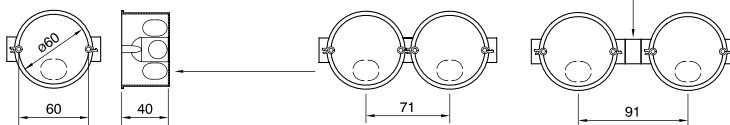

SQUARE GW 24 231

