

# System

## Plates and modular devices

A range of modular devices ideal for flush-mounting solutions (for rectangular or square boxes), surface-mounting solutions, and for special applications. The domestic range is distinguished by its black satin or white gloss devices and plates in 14 colours and two different forms, modern or classic, with glossy finish. The range includes commands, socket-outlets, protection, indicators, connectors and devices for the control, safety and comfort of your home.



**Technical characteristics page 355**

## TOP SYSTEM PLATES

### TECHNOPOLYMER



GW 22 503

#### TOP SYSTEM - CLOUD WHITE

Code	Description	Configuration	For support codes	Pack Carton
GW 22 501	1 gang		GW24201	96
GW 22 502	2 gang		GW24262	96
GW 22 503	3 gang		GW24201	96
GW 22 504	4 gang		GW24202	96
GW 22 506	6 gang		GW24230	48
GW 22 507	4+4 gang	Overlapping	GW24240	6
GW 22 508	6+6 gang	Overlapping	GW24241	6

CHARACTERISTICS: glossy finish.



GW 22 513

#### TOP SYSTEM - TONER BLACK

Code	Description	Configuration	For support codes	Pack Carton
GW 22 511	1 gang		GW24201	96
GW 22 512	2 gang		GW24262	12
GW 22 513	3 gang		GW24201	96
GW 22 514	4 gang		GW24202	12
GW 22 516	6 gang		GW24230	8
GW 22 517	4+4 gang	Overlapping	GW24240	6

CHARACTERISTICS: glossy finish.

### TECHNOPOLYMER, IN PASTEL COLOURS

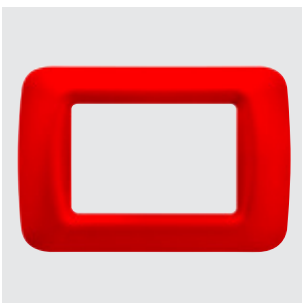

GW 22 523

#### TOP SYSTEM - GERANIUM RED

Code	Description	Configuration	For support codes	Pack Carton
GW 22 521	1 gang		GW24201	24
GW 22 522	2 gang		GW24262	12
GW 22 523	3 gang		GW24201	24
GW 22 524	4 gang		GW24202	12
GW 22 526	6 gang		GW24230	8
GW 22 527	4+4 gang	Overlapping	GW24240	6

CHARACTERISTICS: glossy finish.

# System



## THE RANGE



The System range includes two families of plates and a wide range of devices available in two versions: white components with glossy finish and black components with satin finish. Designed to offer optimum application versatility, the System devices can be flush-mounted or surface-mounted for top practicality and elegance.

## SYSTEM SOLUTIONS



The System devices use a wide range of accessories and can be installed in any electrical system: in rectangular flush-mounting and surface-mounting boxes, in boxes for interface with mini trunking, on profiles and DIN rails, in 27 Combi containers

## INSTALLATION FLEXIBILITY



The System domestic range is a system offering maximum application flexibility. Versatile, thanks to the dual coupling possibility (on the front or rear of the support) that makes component assembly and release operations easier and quicker.

DOMESTIC RANGES

## General characteristics

### TECHNICAL DATA AND REFERENCE STANDARDS

Component	Reference standards	Essential electrical data*			Prolonged operation (no. position changes)	Resistance to abnormal heat and fire	
		Resistance at test voltage (V)	Insulation resistance (MΩ)	Breaking capacity or category of use		Thermo-pressure with ball (°C)	Glow Wire Test (°C)
Commands	EN 60669-1	2000 at 50 Hz for 1 minute	> 5	1.25 In (200 position changes)	40,000 at In 250V AC cos φ = 0.6	125	850
Socket-outlets	IEC 60884-1			1.25 In (100 position changes)	10,000 at In 250V AC cos φ = 0.8		
Latching relays	EN 60669-1 / EN 60669-2-2			1.25 In (200 position changes)	50,000 at In 250V AC cos φ = 0.6		
Momentary relays	EN 60669-1 / EN 60669-2-2						
Miniature circuit breakers	EN 60898-1		2** ÷ 5	3KA	8,000		
Residual current circuit breakers	EN 61009-1 / EN 61008-1			3KA	4,000		
Supports and plates	EN 60669-1	-	-	-	-	70	650

\* For rated voltages and currents, see the specifications in the single codes.

\*\* The value of 2 MΩ refers to a special condition established by the standards given alongside.

### BEHAVIOUR WITH CHEMICAL AND ATMOSPHERIC AGENTS

Component	Agent	Water	Saline solution	Acids		Bases		Solvents			Mineral oil	UV rays	
				Concentrated	Diluted	Concentrated	Diluted	Hexane	Benzol	Acetone			Ethyl alcohol
Plates		Resistant	Resistant	Limited resistance	Resistant	Resistant	Resistant	Limited resistance	Not resistant	Not resistant	Not resistant	Limited resistance	Resistant
SYSTEM devices		Resistant	Limited resistance	Not resistant	Limited resistance	Limited resistance	Resistant	Resistant	Resistant	Resistant	Resistant	Resistant	Resistant

\* The resistance values given are valid for an ambient temperature no higher than 40°C.

Terminal resistance to cable traction: > 50N  
Device hold on support: > 0.6J

### TERMINAL TIGHTENING CAPACITY

Stranded wires		Solid wires	
Minimum	Maximum	Minimum	Maximum
0.75 mm <sup>2</sup>	2 x 4 mm <sup>2</sup>	0.5 mm <sup>2</sup>	2x2.5 mm <sup>2</sup>

# System

## TOP SYSTEM PLATES

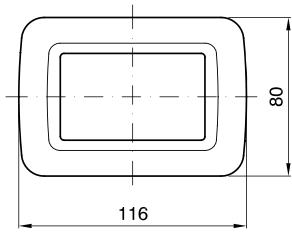

1 GANG - 2 GANG - 3 GANG

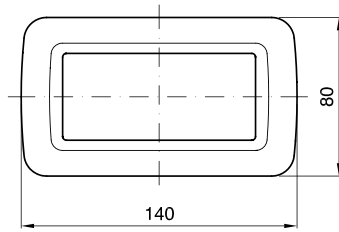

4 GANG

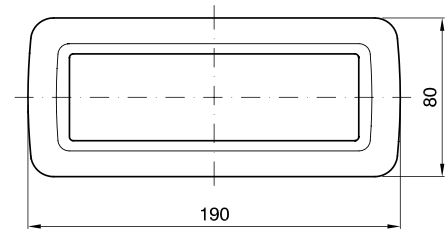

6 GANG

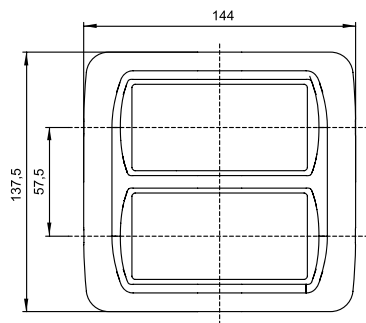

4 + 4 GANG

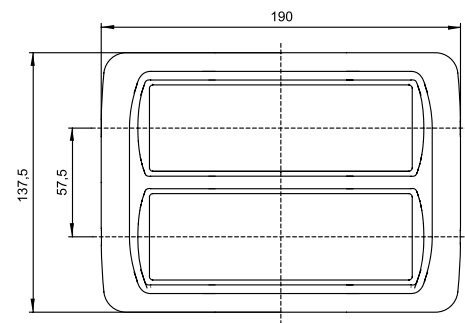

6 + 6 GANG

## VIRNA PLATES

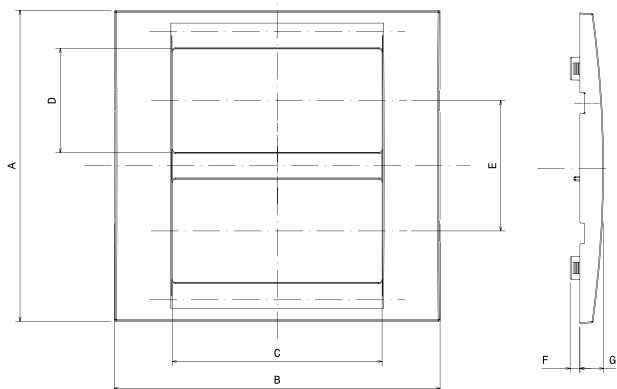
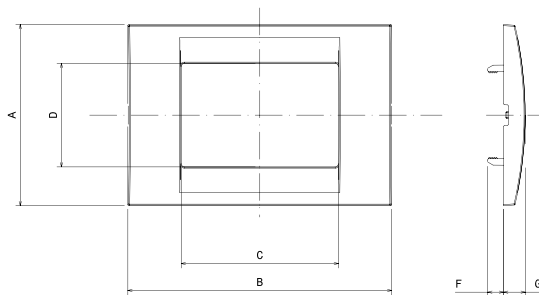

	A	B	C	D	E	F	G
1 GANG	80	116.5	23	45.7		7	9.5
2 GANG	80	116.5	46.4	45.7			9.5
3 GANG	80	116.5	69.4	45.7		7	9.5
4 GANG	80	139.6	92.6	45.7		7	9.5
6 GANG	80	190	138.8	45.7		4.3	9.5
(4+4) 8 GANG	137.2	143.8	92.6	45.7	57.5	4.3	10.5
(6+6) 12 GANG	137.2	190	138.8	45.7	57.5	4.3	10.5

**COMPACT PLATES**

1 GANG - 2 GANG - 3 GANG - 4 GANG

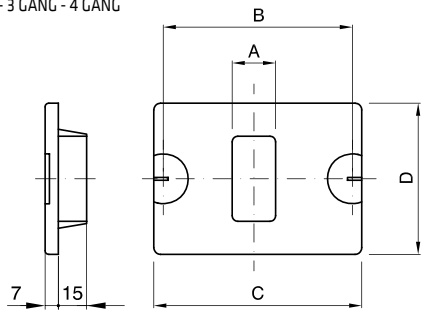

3 + 3 GANG

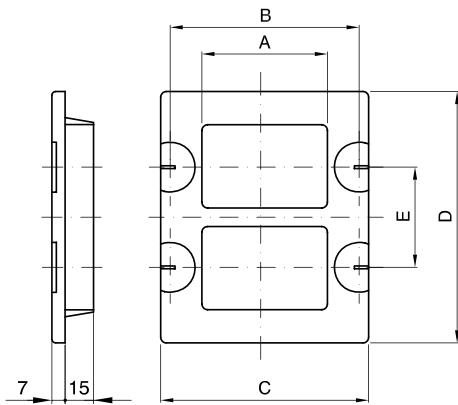

Compact					
Code	GW 24 001	GW 24 002	GW 24 003	GW 24 004	GW 24 005
A	1 GANG	2 GANG	3 GANG	4 GANG	3 + 3 GANG
B	83.5	83.5	83.5	108.5	83.5
C	110	110	110	134	110
D	80	80	80	80	133
E	-	-	-	-	51