

Compact relay with maximum functions

Purpose:

ZUBR D2 voltage monitoring relay is designed to protect equipment from excessive voltage fluctuations. In case of emergency, the device switches off the load. Relays are used in single-phase alternating current networks (230 V). It is additionally equipped with thermal protection.



ZUBR D2



White
indication



Red
indication

Why do professionals prefer ZUBR D2?

High reliability and durability

Using a switching power supply increases the life of devices. Absence of metal film capacitors, which eventually lose their properties (their capacity) as a result of dielectric degradation.

Decreased energy consumption.

The use of a switching power supply reduces its own energy consumption.

The solid power section eliminates possible heating at the connection points.

Professional electricians value us for quality and functionality

Watch detailed review of ZUBR D2 and its installation in the switchboard for the apartment in the video on YouTube — elektrik-sam.info

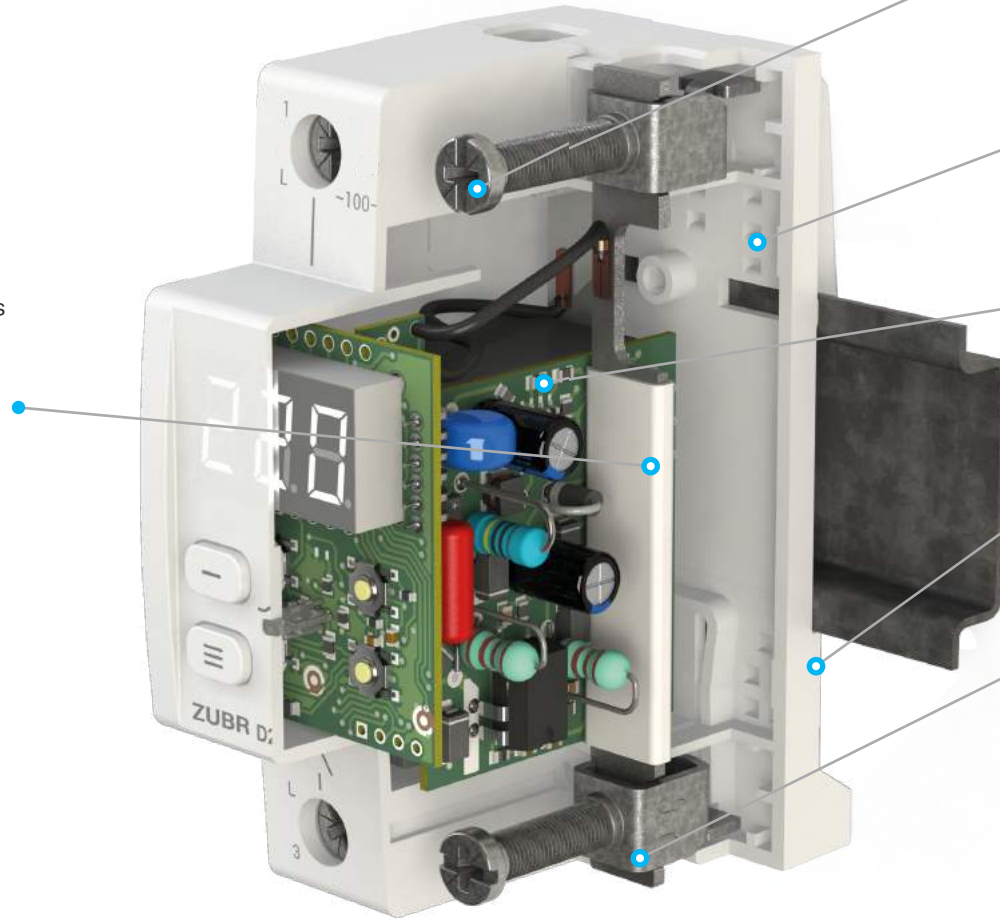

Well-designed construction of the case

• **Easy standardized connection:** no need to use when connecting the neutral terminal. Convenient connection of phase and zero input — to upper terminals, output — to lower.

• **Special ventilation holes** for removing heat from the device.

Enhanced safety

• **Internal temperature sensor.** If the temperature inside the case exceeds 80 °C, the relay will switch off the voltage, until the temperature turns to normal.

• **The case which does not support combustion** from self-extinguishing European polycarbonate with addition of flame retardants, which interfere with combustion.

• **Powerful crimp terminals**

Design and usability settings

Screen brightness adjustment

Abbreviations for the names of menu items decoded. Press the «i» button to see the full name of the menu section on the screen.



Anna Nizeika
Commercial Director

+60% — D2 sales growth, compared to the previous year. This is the fastest growth among ZUBR relays. If D2 were stocks, I would invest in them! 🤖🤖🤖



Comparison of single-phase DIN rail voltage monitoring relays



MF



D2



Dt



D

	MF	D2	Dt	D
Rated load current	25, 32, 40, 50, 63 A	40, 50, 63 A	25, 32, 40, 50, 63 A	16, 25, 32, 40, 50, 63 A
Housing width	3 modules	2 modules	3 modules	3 modules
Restrictions on current	✓	✗	✗	✗
Restrictions on active power	✓	✗	✗	✗
View the latest voltage alarm	✓	✓	✓	✓
Alarm log	✗	100 values	50 values	50 values
Switch-on load delay Adjustable time before switching on the load after an accident. It is used to protect compressor equipment, such as refrigerators to increase the service life.	✓	✓	✓	✓
Choice of delay type Types of switch-on delay: countdown from the beginning of the accident or from the moment of voltage recovery.	✗	✓	✗	✗
Thermal protection	✓	✓	✓	✗
True RMS	✓	✓	✓	✗
Professional load switch-off model	✓	✓	✓	✗
Correction of screen indications	voltage and current	voltage	voltage	voltage
Adjustable delay in case of voltage failure For more accurate adjustment of the protection response time for AC fails.	✗	✓	✗	✗
Screen brightness adjustment	✗	✓	✗	✗
Switching power supply	✓	✓	✗	✗