

► CZUJNIK RUCHU MIKROFALOWY, WPUSZCZANY **CM-5**  
Recessed microwave motion sensor

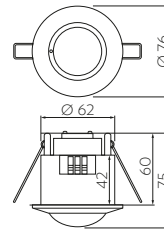

AE-CM5000-00	tworzywo, plastic	biały, white	100 g	5901867108883

► CZUJNIK RUCHU MIKROFALOWY **CM-6**  
Microwave motion sensor

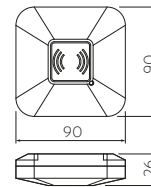

AE-CM6000-00	400 W	800 W	PC	biały, white	100 g	5902801285189

► CZUJNIK RUCHU MIKROFALOWY **CM-9**  
Microwave motion sensor

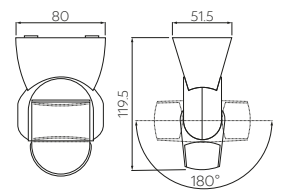
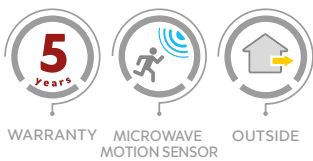

AE-CM9000-00	tworzywo, plastic,	biały, white	161 g	5901867196972
AE-CM9000-10		czarny, black		5901867196996

► CZUJNIK RUCHU MIKROFALOWY, WPUSZCZANY **CM-15**  
Recessed microwave motion sensor

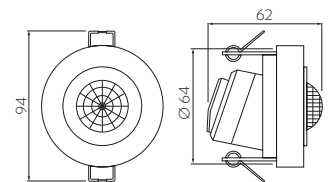

AE-CM1500-00	tworzywo, plastic	biały, white	103 g	5902801002519