

## Comparații de rele electromecanice și socuri

B

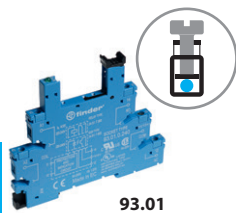

93.01

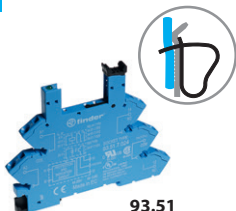

93.51

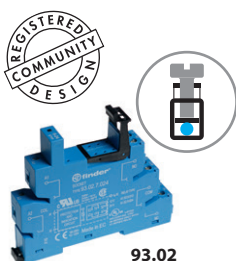

93.02



93.52

Omologări

(conform tipului):



Certain relay/socket combinations

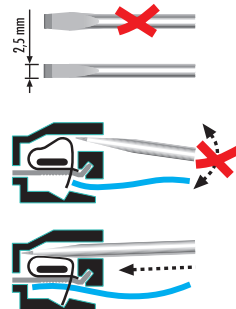

### Terminal cu șurub - releu cu 1 contact 6 A

Cod interfață modulară	Tensiunea bobinei	Releu	Soclu
38.51.0.012.0060	12 V C.A./C.C.	34.51.7.012.0010	93.01.0.024
38.51.0.024.0060	24 V C.A./C.C.	34.51.7.024.0010	93.01.0.024
38.51.0.048.0060	48 V C.A./C.C.	34.51.7.048.0010	93.01.0.060
38.51.0.060.0060	60 V C.A./C.C.	34.51.7.060.0010	93.01.0.060
38.51.0.125.0060	(110...125) V C.A./C.C.	34.51.7.060.0010	93.01.0.125
38.51.0.240.0060	(220...240) V C.A./C.C.	34.51.7.060.0010	93.01.0.240
38.51.3.125.0060	(110...125) V C.A./C.C.	34.51.7.060.0010	93.01.3.125
38.51.3.240.0060	(230...240) V C.A.	34.51.7.060.0010	93.01.3.240
38.51.7.006.0050	6 V C.C.	34.51.7.005.0010	93.01.7.024
38.51.7.012.0050	12 V C.C.	34.51.7.012.0010	93.01.7.024
38.51.7.024.0050	24 V C.C.	34.51.7.024.0010	93.01.7.024
38.51.7.048.0050	48 V C.C.	34.51.7.048.0010	93.01.7.060
38.51.7.060.0050	60 V C.C.	34.51.7.060.0010	93.01.7.060
38.51.8.240.0060	(230...240) V C.A.	34.51.7.060.0010	93.01.8.240

### Terminal cu prindere rapidă - releu cu 1 contact 6 A

Cod interfață modulară	Tensiunea bobinei	Releu	Soclu
38.61.0.012.0060	12 V C.A./C.C.	34.51.7.012.0010	93.51.0.024
38.61.0.024.0060	24 V C.A./C.C.	34.51.7.024.0010	93.51.0.024
38.61.0.125.0060	(110...125) V C.A./C.C.	34.51.7.060.0010	93.51.0.125
38.61.0.240.0060	(220...240) V C.A./C.C.	34.51.7.060.0010	93.51.0.240
38.61.3.125.0060	(110...125) V C.A./C.C.	34.51.7.060.0010	93.51.3.125
38.61.3.240.0060	(230...240) V C.A.	34.51.7.060.0010	93.51.3.240
38.61.7.012.0050	12 V C.C.	34.51.7.012.0010	93.51.7.024
38.61.7.024.0050	24 V C.C.	34.51.7.024.0010	93.51.7.024
38.61.8.240.0060	(230...240) V C.A.	34.51.7.060.0010	93.51.8.240

### Terminal cu șurub - releu cu 1 contact 16 A

Cod interfață modulară	Tensiunea bobinei	Releu	Soclu
38.01.7.012.0050	12 V C.C.	41.61.9.012.0010	93.02.7.024
38.01.7.024.0050	24 V C.C.	41.61.9.024.0010	93.02.7.024
38.01.7.060.0050	60 V C.C.	41.61.9.060.0010	93.02.7.060
38.01.0.024.0060	24 V C.A./C.C.	41.61.9.024.0010	93.02.0.024
38.01.0.060.0060	60 V C.A./C.C.	41.61.9.060.0010	93.02.0.060
38.01.0.125.0060	125 V C.A./C.C.	41.61.9.110.0010	93.02.0.125
38.01.0.240.0060	240 V C.A./C.C.	41.61.9.110.0010	93.02.0.240
38.01.8.230.0060	230 V C.A.	41.61.9.110.0010	93.02.8.230

### Terminal cu prindere rapidă - releu cu 1 contact 16 A

Cod interfață modulară	Tensiunea bobinei	Releu	Soclu
38.11.7.012.0050	12 V C.C.	41.61.9.012.0010	93.52.7.024
38.11.7.024.0050	24 V C.C.	41.61.9.024.0010	93.52.7.024
38.11.7.060.0050	60 V C.C.	41.61.9.060.0010	93.52.7.060
38.11.0.024.0060	24 V C.A./C.C.	41.61.9.024.0010	93.52.0.024
38.11.0.060.0060	60 V C.A./C.C.	41.61.9.060.0010	93.52.0.060
38.11.0.125.0060	125 V C.A./C.C.	41.61.9.110.0010	93.52.0.125
38.11.0.240.0060	240 V C.A./C.C.	41.61.9.110.0010	93.52.0.240
38.11.8.230.0060	230 V C.A.	41.61.9.110.0010	93.52.8.230

### Terminal cu șurub - releu cu 2 contacte 8 A

Cod interfață modulară	Tensiunea bobinei	Releu	Soclu
38.52.0.024.0060	24 V C.A./C.C.	41.52.9.024.0010	93.02.0.024
38.52.0.060.0060	60 V C.A./C.C.	41.52.9.060.0010	93.02.0.060
38.52.0.125.0060	(110...125) V C.A./C.C.	41.52.9.110.0010	93.02.0.125
38.52.0.240.0060	(220...240) V C.A./C.C.	41.52.9.110.0010	93.02.0.240
38.52.7.012.0050	12 V C.C.	41.52.9.012.0010	93.02.7.024
38.52.7.024.0050	24 V C.C.	41.52.9.024.0010	93.02.7.024
38.52.7.060.0050	60 V C.C.	41.52.9.060.0010	93.02.7.060
38.52.8.230.0060	(230...240) V C.A.	41.52.9.110.0010	93.02.8.230

### Terminal cu prindere rapidă - releu cu 2 contacte 8 A

Cod interfață modulară	Tensiunea bobinei	Releu	Soclu
38.62.0.024.0060	24 V C.A./C.C.	41.52.9.024.0010	93.52.0.024
38.62.0.060.0060	60 V C.A./C.C.	41.52.9.060.0010	93.52.0.060
38.62.0.125.0060	(110...125) V C.A./C.C.	41.52.9.110.0010	93.52.0.125
38.62.0.240.0060	(220...240) V C.A./C.C.	41.52.9.110.0010	93.52.0.240
38.62.7.012.0050	12 V C.C.	41.52.9.012.0010	93.52.7.024
38.62.7.024.0050	24 V C.C.	41.52.9.024.0010	93.52.7.024
38.62.7.060.0050	60 V C.C.	41.52.9.060.0010	93.52.7.060
38.62.8.230.0060	(230...240) V C.A.	41.52.9.110.0010	93.52.8.230

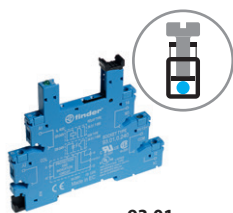

93.01

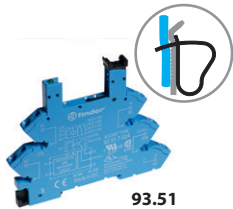

93.51

Omologări  
(conform tipului):



Comparație releu/  
soclu

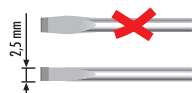

## Comparații de rele electronice SSR și socluri - 6.2 mm lățime

### Terminal cu șurub

Cod interfață modulară	Tensiune de intrare	Releu	Soclu
38.81.7.006.xxxx	6 V C.C.	34.81.7.005.xxxx	93.01.7.024
38.81.7.024.xxxx	24 V C.C.	34.81.7.024.xxxx	93.01.7.024
38.81.7.060.xxxx	60 V C.C.	34.81.7.060.xxxx	93.01.7.060
38.81.0.125.xxxx	(110...125) V C.A./C.C.	34.81.7.060.xxxx	93.01.0.125
38.81.0.240.xxxx	(220...240) V C.A./C.C.	34.81.7.060.xxxx	93.01.0.240
38.81.3.125.xxxx	(110...125) V C.A./C.C.	34.81.7.060.xxxx	93.01.3.125
38.81.3.240.xxxx	(230...240) V C.A.	34.81.7.060.xxxx	93.01.3.240

### Terminal cu prindere rapidă

Cod interfață modulară	Tensiune de intrare	Releu	Soclu
38.91.7.006.xxxx	6 V C.C.	34.81.7.005.xxxx	93.51.7.024
38.91.7.024.xxxx	24 V C.C.	34.81.7.024.xxxx	93.51.7.024
38.91.7.060.xxxx	60 V C.C.	34.81.7.060.xxxx	93.51.7.060
38.91.0.125.xxxx	(110...125) V C.A./C.C.	34.81.7.060.xxxx	93.51.0.125
38.91.0.240.xxxx	(220...240) V C.A./C.C.	34.81.7.060.xxxx	93.51.0.240
38.91.3.125.xxxx	(110...125) V C.A./C.C.	34.81.7.060.xxxx	93.51.3.125
38.91.3.240.xxxx	(230...240) V C.A.	34.81.7.060.xxxx	93.51.3.240

Exemplu: .xxxx  
.9024  
.7048  
.8240

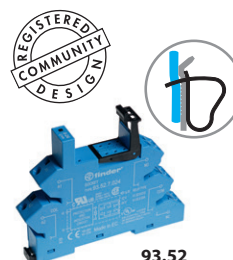

93.52

Omologări  
(conform tipului):



## Comparații de rele electronice SSR și socluri - 14 mm lățime

### Terminal cu șurub

Cod interfață modulară	Tensiune de intrare	Releu	Soclu
38.31.0.024.xxxx	24 V C.A./C.C.	41.81.7.024.xxxx	93.02.0.024
38.31.7.012.xxxx	12 V C.C.	41.81.7.012.xxxx	93.02.7.024
38.31.7.024.xxxx	24 V C.C.	41.81.7.024.xxxx	93.02.7.024

### Terminal cu prindere rapidă

Cod interfață modulară	Tensiune de intrare	Releu	Soclu
38.41.0.024.xxxx	24 V C.A./C.C.	41.81.7.024.xxxx	93.52.0.024
38.41.7.012.xxxx	12 V C.C.	41.81.7.012.xxxx	93.52.7.024
38.41.7.024.xxxx	24 V C.C.	41.81.7.024.xxxx	93.52.7.024

## Comparații de SSR/EMR și socluri cu temporizator

### Terminal cu șurub

Cod interfață modulară	Tensiunea de intrare/ bobinei	Releu	Soclu
38.21.0.012.0060	12 V C.A./C.C.	34.51.7.012.0010	93.21.0.024
38.21.0.024.0060	24 V C.A./C.C.	34.51.7.024.0010	93.21.0.024
38.21.0.024.xxxx	24 V C.A./C.C.	34.81.7.024.xxxx	93.21.0.024

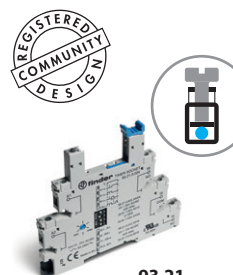

93.21

Omologări  
(conform tipului):

