

## FUSE BASE PBS 2 (400 A, 690 V) PBS 3 (630 A, 690 V)

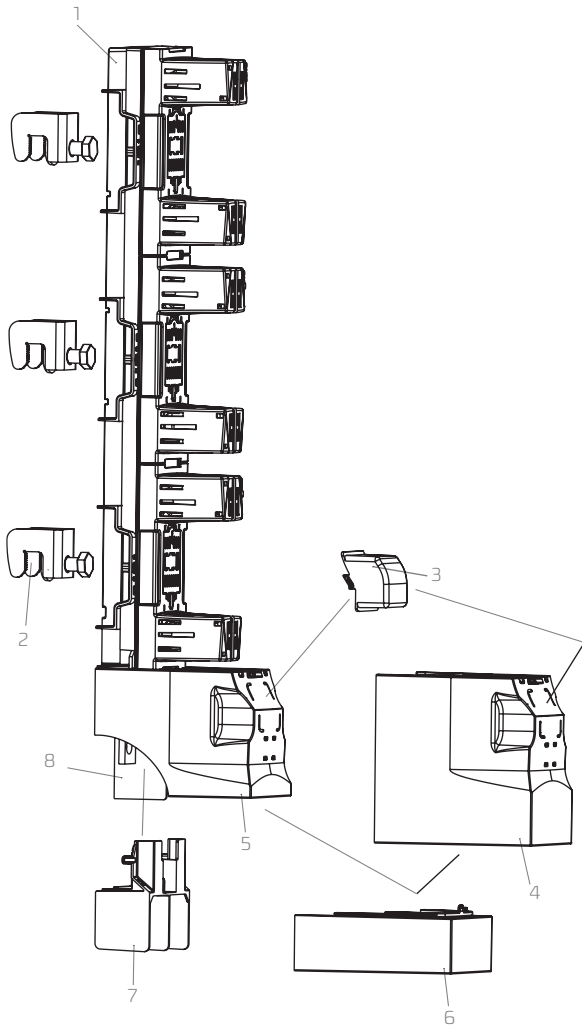

Option of fuse link  
state indication  
by neon indicator tube

Labels on busbar  
terminals acces covers

Clip with label

Terminal shroud label



### DESCRIPTON

1. Main base
2. Hooked clamp – for installation on to busbar system 1115281037T
3. Terminal shroud for fuse switch disconnecter with double V-clamps (2 x 240 mm<sup>2</sup>) 51-945480-011
4. Terminal shroud (long) 51-945480-011
5. Terminal shroud (short) 51-930271-011
6. Bottom adjusting shroud 51-930313-011
7. Cable terminal protective cover 51-930272-011
8. Protective barrier

## PBS 3 (630 A, 690 V)



PBS 3-V

PBS 3-V  
with fuse link shrouds

Table 69. Technical data

Parameter		PBS 3
Size		3
Rated thermal current $I_{th}$	A	630
Rated voltage $U_n$	V	690
Rated insulation voltage $U_i$	V	1000
Rated frequency	Hz	50-60
Rated power dissipation	W	60
Rated short-circuit withstand current	kA	100
Mechanical durability	Number of cycles	100
IP degree of protection without fuse links installed	-	20
IP degree of protection with fuse links and fuse link shrouds installed	-	20
Size of fuse links		3

Accessories on page 70, 71

Table 70. Versions

Version		Weight	Article No.
PBS 3-V	cable terminals: V-terminals with V-clamps (35-300 SW)	4,0 kg	63-811639-021
PBS 3-M	cable terminals: screw terminals with pressed nuts M12 (M12 screw)	4,1 kg	63-811639-041
PBS 3-2V	cable terminals: 2V-terminals with double V-clamps (2 x 50- 240 mm <sup>2</sup> )	4,8 kg	63-811639-061

Table 71. PBS 3 terminal clamps

Description	PBS 3-V	PBS 3-2V	PBS 3-2V	PBS 3-M		
Clamp	V-clamp 35-300SW-B	V-clamp 2/50-300SW-B	V-clamp HS 2/50-240-C*	M-screw M12**		
Drawing of clamp						
Cross-section of conductors	V-clamp for direct fixing of conductor with bare end with cross-section of:					
	35 - 185 mm <sup>2</sup>	35 - 240 mm <sup>2</sup>	50 - 185 mm <sup>2</sup>	50 - 240 mm <sup>2</sup>	50 - 185 mm <sup>2</sup>	50 - 240 mm <sup>2</sup>
	35 - 240 mm <sup>2</sup>	35 - 300 mm <sup>2</sup>	50 - 240 mm <sup>2</sup>	50 - 300 mm <sup>2</sup>	50 - 240 mm <sup>2</sup>	50 - 300 mm <sup>2</sup>
Tightening torque	30 Nm		30 Nm		40 Nm	56 Nm

For stranded conductors using cable ferrules is recommended

\*) if the fuse switch disconnector with a 2V-type clamp is to be equipped with a steel V-clamp HS 2/50-240-C, it should be included in the order

\*\*) bars of maximum width of 40 mm and maximum thickness of 8 mm can be fixed to M type screw terminals when protective barrier between phases is installed

Apartor takes responsibility for technical quality of V-terminals manufactured only by the company. Minimum tightening torque (M12 screw) for screws fixing fuse switch disconnector to busbar system – 32 Nm, recommended tightening torque for screws and nuts with property class 8.8 – 56 Nm.

PBS 00-SM

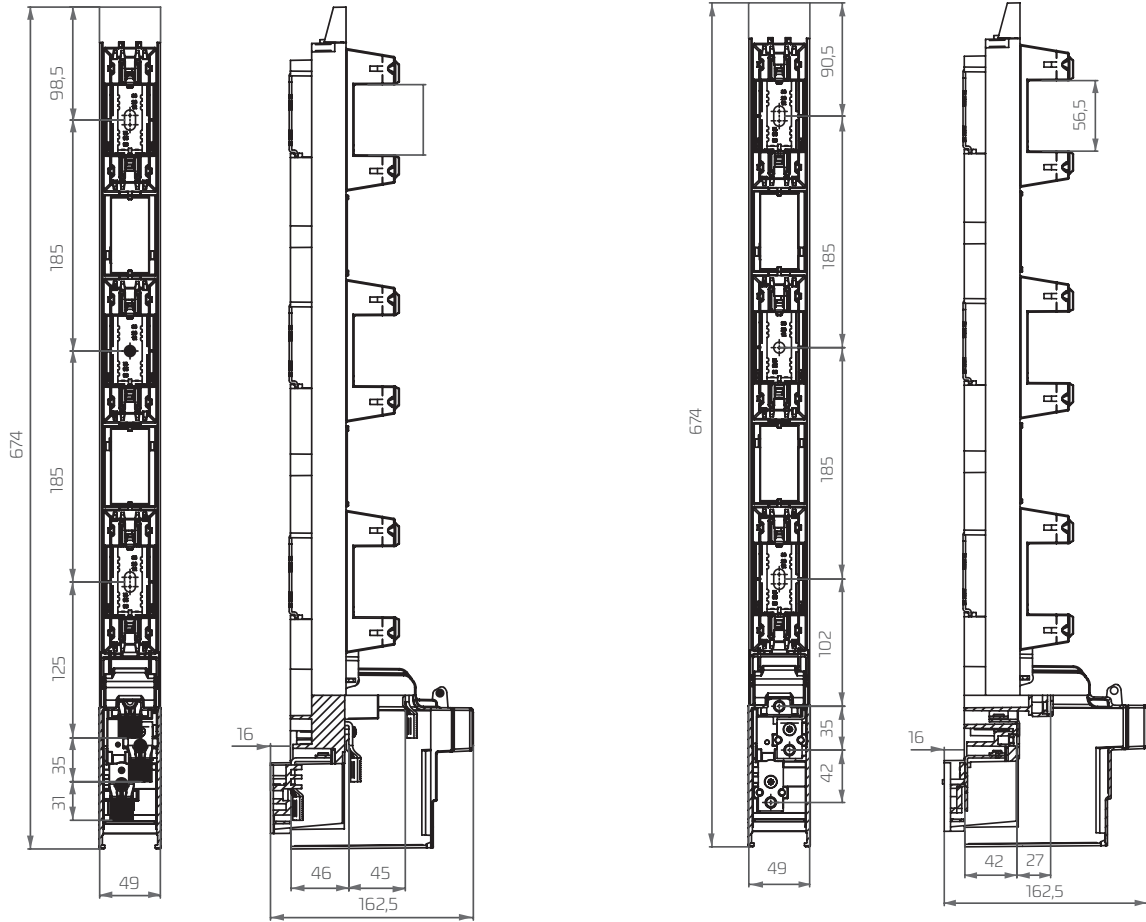

PBS 2 | PBS 3

