

FUSE BASE PBS 2 (400 A, 690 V) PBS 3 (630 A, 690 V)

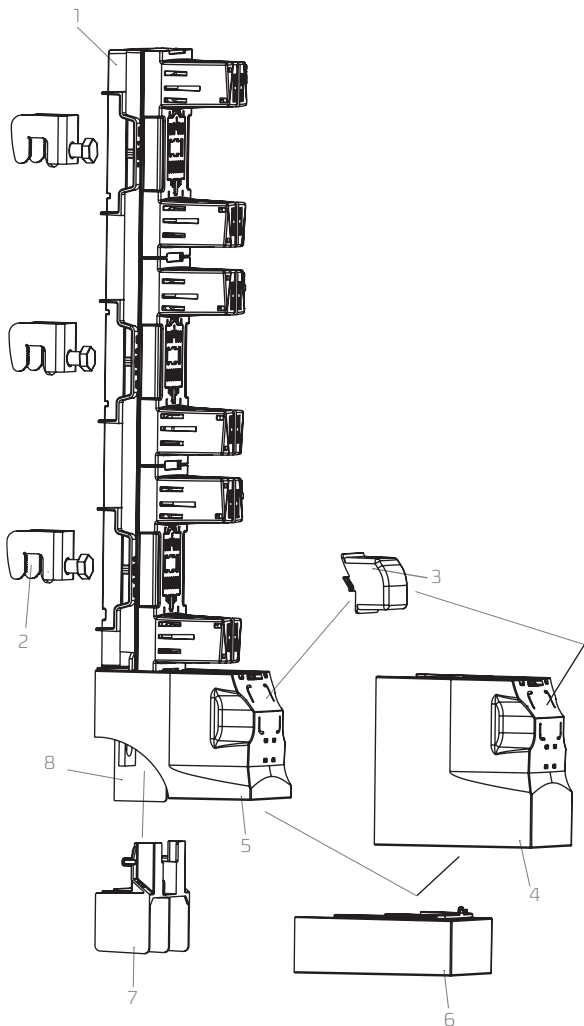

Option of fuse link state indication by neon indicator tube

Labels on busbar terminals access covers

Clip with label

Terminal shroud label



DESCRIPTION

1. Main base
2. Hooked clamp – for installation on to busbar system 1115281037T
3. Terminal shroud for fuse switch disconnecter with double V-clamps (2 x 240 mm²) 51-945480-011
4. Terminal shroud (long) 51-945480-011
5. Terminal shroud (short) 51-930271-011
6. Bottom adjusting shroud 51-930313-011
7. Cable terminal protective cover 51-930272-011
8. Protective barrier

PBS 2 (400 A, 690 V)

Fuse rail designed for operation with NH1 and NH2 fuse links

Table 66. Technical data

| Parameter | PBS 2 | |
|---|------------------|--------------------|
| Size | 2 | |
| Rated thermal current I_{th} | A | 250(NH1), 400(NH2) |
| Rated voltage U_n | V | 690 |
| Rated insulation voltage U_i | V | 1000 |
| Rated frequency | Hz | 50-60 |
| Rated power dissipation | W | 45 |
| Rated short-circuit withstand current | kA | 100 |
| Mechanical durability | Number of cycles | 100 |
| IP degree of protection without fuse links installed | - | 20 |
| IP degree of protection with fuse links and fuse link shrouds installed | - | 20 |
| Size of fuse links | 1,2 | |

Accessories on page 70, 71



PBS 2-V

PBS 2-V
with fuse link shrouds

Table 67. Versions

| Version | | Weight | Article No. |
|----------|--|--------|---------------|
| PBS 2-V | cable terminals: V-terminals with V-clamps (35-300 mm ²) | 3,2 kg | 63-811639-011 |
| PBS 2-M | cable terminals: screw terminals with pressed nuts M10 (M10 screw) | 3,1 kg | 63-811639-031 |
| PBS 2-2V | cable terminals: 2V-terminals with double Vclamps (2 x 50- 240 mm ²) | 3,8 kg | 63-811639-051 |

Table 68. PBS 2 terminal clamps

| Description | PBS 2-V | PBS 2-2V | PBS 2-2V | PBS 2-M | | |
|-----------------------------|---|--------------------------|--------------------------|--------------------------|--------------------------|--------------------------|
| Clamp | V-clamp 35-300SW-B | V-clamp 2/50-300SW-B | V-clamp HS 2/50-240-C* | M-screw M10** | | |
| Drawing of clamp | | | | | | |
| Cross-section of conductors | V-clamp for direct fixing of conductor with bare end with cross-section of: | | | | | |
| | 35 - 185 mm ² | 35 - 240 mm ² | 50 - 185 mm ² | 50 - 240 mm ² | 50 - 185 mm ² | 50 - 240 mm ² |
| | 35 - 240 mm ² | 35 - 300 mm ² | 50 - 240 mm ² | 50 - 300 mm ² | 50 - 240 mm ² | 50 - 300 mm ² |
| Tightening torque | 30 Nm | | 30 Nm | | 40 Nm | |
| | | | | | 32 Nm | |

For stranded conductors using cable ferrules is recommended

*) if the fuse switch disconnector with a 2V-type clamp is to be equipped with a steel V-clamp HS 2/50-240-C, it should be included in the order

***) Bars of maximum width of 40 mm and maximum thickness of 8 mm can be fixed to M type screw terminals when protective barrier between phases is installed. Apator takes responsibility for technical quality of V-terminals manufactured only by the company. Minimum tightening torque (M10 screw) for screws fixing fuse switch disconnector to busbar system – 32 Nm, recommended tightening torque for screws and nuts with property class 8.8 – 56 Nm.

PBS 00-SM

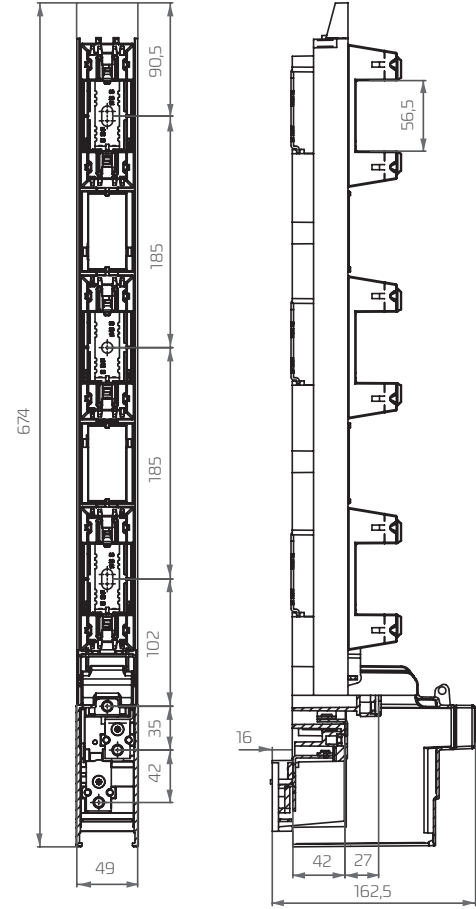
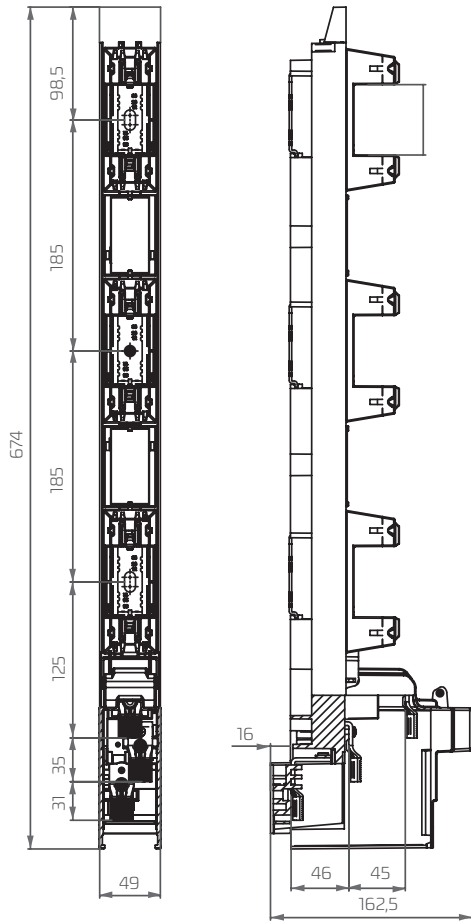

PBS 2 | PBS 3

