

## FUSE RAIL PBS 00/100 mm (160 A, 690 V)

For 100 mm busbar system

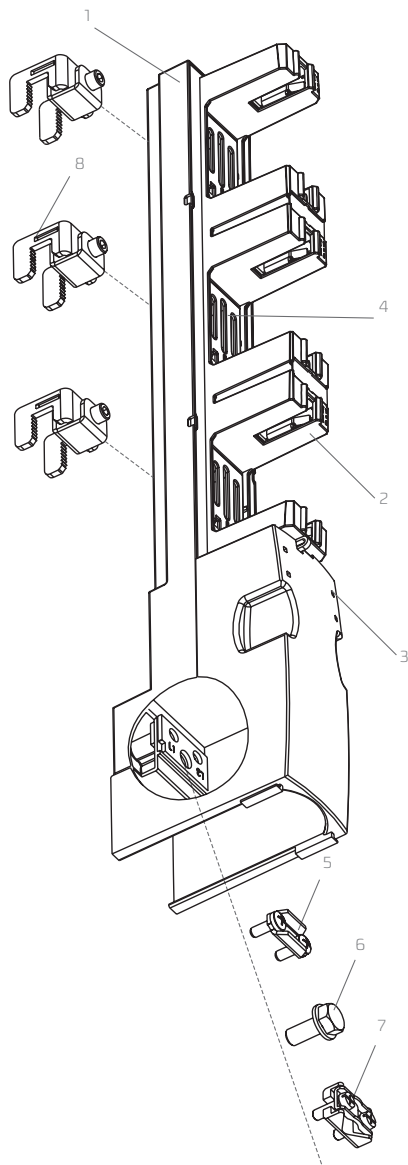

### DESCRIPTION

1. Main base
2. Protective contact cover
3. Terminal shroud
4. Busbar terminals acces covers
5. S-bridge clamp
6. M8 screw
7. V-shape clamp for sector-shaped conductor
8. Hooked clamp



PBS 00/100 mm

## PBS 00/100 mm (160 A, 690 V)



PBS 00/100 mm

Table 60. Technical data

Parameter		PBS 00/100 mm
Size		00
Rated thermal current $I_{th}$	A	160
Rated voltage $U_n$	V	690
Rated insulation voltage $U_i$	V	1000
Rated frequency	Hz	50-60
Rated power dissipation	W	12
Rated short-circuit withstand current	kA	100
Mechanical durability	Number of cycles	100
IP degree of protection	-	00
Size of fuse links		00

Accessories on page 69

Table 61. Versions

Version		Weight	Article No.
PBS 00/100 mm	cable terminals: bridge terminals with bridgeclamps (S) 4-70 mm <sup>2</sup> , screw terminals with M8 screws	1,0 kg	63-811627-011
PBS 00/100 mm-V	cable terminals: V-terminals with V-clamps 25-150SW	1,1 kg	63-811627-021

Table 62. PBS 00/100 mm terminal clamps

Description	PBS 00/100 mm			
Clamp	S-bridge clamp 2 x M5 x 25	M8 screw*	V-clamp 25-150 SW	HM 10-120
Picture of clamp				
Drawing of clamp				
Cross-section of conductors	4-70 mm <sup>2</sup>	Conductor with lug terminal max 185 mm <sup>2</sup>	re ● 16 mm <sup>2</sup> -95 mm <sup>2</sup> se ◆ 25 mm <sup>2</sup> -150 mm <sup>2</sup> rm ⊗ 16 mm <sup>2</sup> -95 mm <sup>2</sup> sm ⊕ 25 mm <sup>2</sup> -150 mm <sup>2</sup>	re ● 10 mm <sup>2</sup> -70 mm <sup>2</sup> se ◆ 25 mm <sup>2</sup> -120 mm <sup>2</sup> rm ⊗ 10 mm <sup>2</sup> -70 mm <sup>2</sup> sm ⊕ 25 mm <sup>2</sup> -95 mm <sup>2</sup>
Tightening torque	3 Nm**	12 Nm**	20 Nm**	15 Nm**

For stranded conductors using cable ferrules is recommended

\*) bars of maximum width of 20 mm and maximum thickness of 5 mm can be fixed to M type screw terminals

\*\*) using tension wrench is recommended

\*\*\*) fuse switch disconnectors with V-terminals are equipped with steel V-clamp HM 10-120 on request

Apator takes responsibility for technical quality of V-terminals manufactured only by the company. Minimum tightening torque (M8 screw) for screws fixing fuse switch disconnector to busbar system – 12 Nm, recommended tightening torque for screws and nuts with property class 8.8 – 21 Nm.

**THREE PHASE  
CURRENT  
MEASUREMENT  
WITH FUSE RAIL PBS**

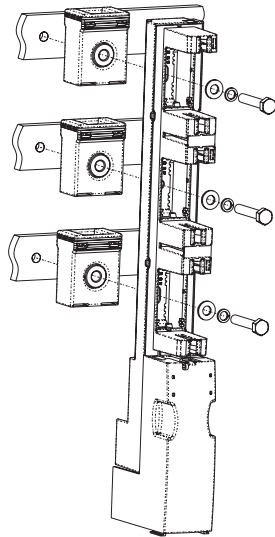

**ONE PHASE  
CURRENT  
MEASUREMENT  
WITH FUSE FUSE RAIL PBS**

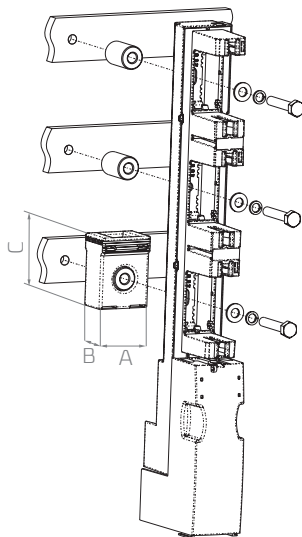

**PBS 00/160 A fuse rails  
CURRENT TRANSFORMER**

A - max. 48mm  
B - max. 35 mm  
C - ~ 65 mm

**DISTANCE SLEEVE**

length 36 mm  
Ø internal = 12,5 mm  
Ø external = 22,5 mm

**PBS 2 i 3 fuse rails  
CURRENT TRANSFORMER**

A - max. 90 mm  
B - max. 35 mm  
C - ~ 80 mm

**DISTANCE SLEEVE**

length 36 mm  
Ø internal = 12,5 mm,  
Ø external = 22,5 mm



Distance sleeve



Current transformer

**PBS 00/100 mm**

