

**FUSE SWITCH DISCONNECTOR ARS 400 pro (400 A, 690 V)**  
**ARS 630 pro (630 A, 690 V)**

For installation on to 185 mm busbar system

Fuse switch disconnector's width 100 mm

Three pole switching - all phases simultaneously or one pole switching - each phase independently

ARS 400 pro, ARS 630 pro

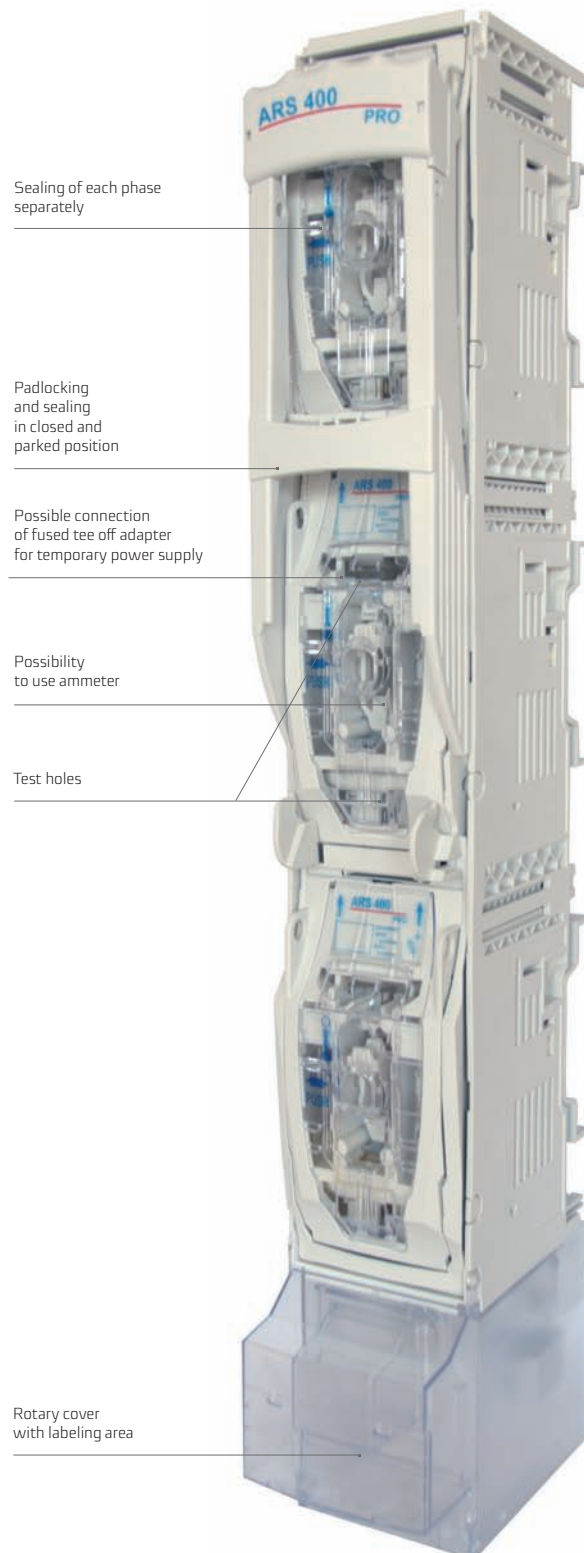

## SWITCH DISCONNECTOR RWS 750 pro (750 A, 500 V)

Switch disconnecter designed for operation with solid links of size 3

Table 34. Technical data

| Parameter                                   | RWS 750 pro      |                  |
|---|------------------|------------------|
| Rated thermal current $I_{th}=I_n$          | A                | 750              |
| Rated voltage $U_n$                         | V                | 500              |
| Utilization category                        | -                | AC-22B           |
| Rated switching voltage $U_e$               | V                | 500              |
| Rated switching current $I_e$               | A                | 750              |
| Rated insulation voltage $U_i$              | V                | 1000             |
| Rated impulse withstand voltage $U_{imp}$   | kV               | 12               |
| Rated short time withstand current $I_{cw}$ | kA               | 15 <sup>1)</sup> |
| Rated frequency                             | Hz               | 50-60            |
| Mechanical durability                       | Number of cycles | 1000             |
| Electrical durability                       |                  | 200              |
| IP degree of protection                     | -                | 30               |
| Solid links size                            | -                | 3                |

Accessories on page. 54, 55

<sup>1)</sup> use of mechanical lock recommended



RWS 750-6-V pro

RWS 750 pro

Table 35. Versions

| Version   | Weight | Article No    |
|---|--------|---------------|
| <b>for installation on 185 mm busbar system, THREE POLE SWITCHING - all phases simultaneously</b> |        |               |
| RWS 750-6-V pro cable terminals: V-terminals: V-clamps 240 mm <sup>2</sup>                        | 6,6 kg | 63-002229-001 |
| RWS 750-6-M pro cable terminals: screw terminals: pressed nuts M12                                | 6,5 kg | 63-002229-002 |
| RWS 750-6-2V pro cable terminals: 2V-terminals: double V-clamps 240 mm <sup>2</sup>               | 7,2 kg | 63-002229-003 |

Table 36. RWS 750 pro terminal clamps

| Description                   | RWS 750-6-V pro   |                          | RWS 750-6-2V pro         |                          | RWS 750-6-2V pro         |                          | RWS 750-6-M pro |
|-------------------------------|---|--------------------------|--------------------------|--------------------------|--------------------------|--------------------------|-----------------|
| Clamp                         | V-clamp 35-300SW-B  |                          | V-clamp 2/50-300SW-B     |                          | V-clamp HS 2/50-240-C*   |                          | M-screw M12**   |
| Drawing of clamp              |   |                          |                          |                          |                          |                          |                 |
| Cross – section of conductors | V-clamp for direct fixing of conductor with bare end with cross-section of: |                          |                          |                          |                          |                          | Lug terminal    |
|                               | 35 - 185 mm <sup>2</sup>  | 35 - 240 mm <sup>2</sup> | 50 - 185 mm <sup>2</sup> | 50 - 240 mm <sup>2</sup> | 50 - 185 mm <sup>2</sup> | 50 - 240 mm <sup>2</sup> |                 |
|                               | 35 - 240 mm <sup>2</sup>  | 35 - 300 mm <sup>2</sup> | 50 - 240 mm <sup>2</sup> | 50 - 300 mm <sup>2</sup> | 50 - 240 mm <sup>2</sup> | 50 - 300 mm <sup>2</sup> |                 |
| Tightening torque             | 30 Nm   |                          | 30 Nm                    |                          | 40 Nm                    |                          | 56 Nm           |

For stranded conductors using cable ferrules is recommended

<sup>\*)</sup> if the fuse switch disconnecter with a 2V-type clamp is to be equipped with a steel V-clamp HS 2/50-240-C, it should be included in the order

<sup>\*\*)</sup> bars of maximum width of 40 mm and maximum thickness of 8 mm can be fixed to M type screw terminals when protective barrier between phases is installed Apator takes responsibility for technical quality of V-terminals manufactured only by the company. Minimum tightening torque (M12 screw) for screws fixing fuse switch disconnecter to busbar system – 32 Nm, recommended tightening torque for screws and nuts with property class 8.8 – 56 Nm.

smartARS 2 pro, smartARS 3 pro (without fuse monitoring module)  
1-phase

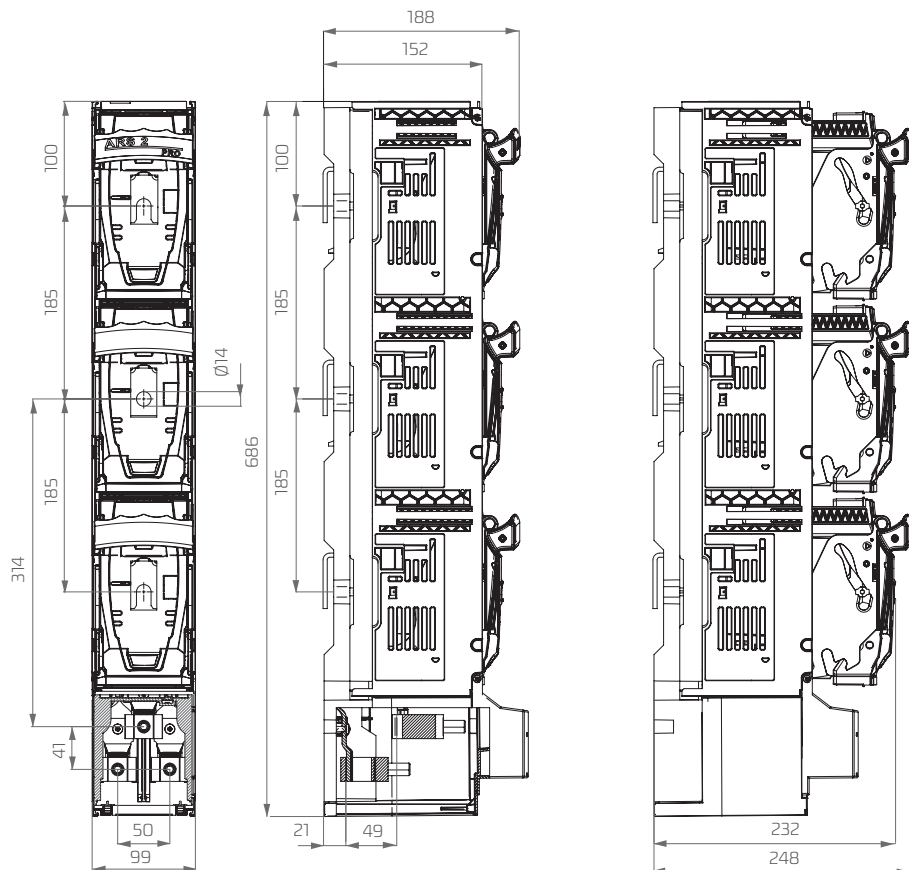

smartARS 2 pro, smartARS 3 pro (without fuse monitoring module)  
RWS 600 pro, RWS 750 pro  
3-phase

