

SWITCH DISCONNECTOR RWS 600 pro (600 A, 690 V)

Switch disconnecter designed for operation with solid links of size 2



RWS 600-6-V pro

Table 31. Technical data

Parameter	RWS 600 pro	
Rated thermal current $I_{th}=I_n$	A	600
Rated voltage U_n	V	690
Utilization category	-	AC-22B
Rated switching voltage U_e	V	690
Rated switching current I_e	A	600
Rated insulation voltage U_i	V	1000
Rated impulse withstand voltage U_{imp}	kV	12
Rated short time withstand current I_{cw}	kA	15 ¹⁾
Rated frequency	Hz	50-60
Mechanical durability	Number of cycles	1000
Electrical durability		200
IP degree of protection	-	30
Solid links size	-	2

Accessories on page 54, 55

¹⁾ use of mechanical lock recommended

Table 32. Versions

Version	Weight	Article No
for installation on 185 mm busbar system, THREE POLE SWITCHING - all phases simultaneously		
RWS 600-6-V pro cable terminals: V-terminals: V-clamps 240 mm ²	5,8 kg	63-002228-001
RWS 600-6-M pro cable terminals: screw terminals: pressed nuts M12	5,7 kg	63-002228-002
RWS 600-6-2V pro cable terminals: 2V-terminals: double V-clamps 240 mm ²	6,4 kg	63-002228-003

Table 33. RWS 600 pro terminal clamps

Description	RWS 600-6-V pro	RWS 600-6-2V pro	RWS 600-6-2V pro	RWS 600-6-M pro
Clamp	V-clamp 35-300SW-B	V-clamp 2/50-300SW-B	V-clamp HS 2/50-240-C*	M-screw M12**
Drawing of clamp				
Cross – section of conductors	V-clamp for direct fixing of conductor with bare end with cross-section of:			Lug terminal
	35 - 185 mm ² 35 - 240 mm ²	50 - 185 mm ² 50 - 240 mm ²	50 - 185 mm ² 50 - 240 mm ²	
Tightening torque	30 Nm	30 Nm	40 Nm	56 Nm

For stranded conductors using cable ferrules is recommended

^{*)} if the fuse switch disconnecter with a 2V-type clamp is to be equipped with a steel V-clamp HS 2/50-240-C, it should be included in the order

^{**)} bars of maximum width of 40 mm and maximum thickness of 8 mm can be fixed to M type screw terminals when protective barrier between phases is installed Apator takes responsibility for technical quality of V-terminals manufactured only by the company. Minimum tightening torque (M12 screw) for screws fixing fuse switch disconnecter to busbar system – 32 Nm, recommended tightening torque for screws and nuts with property class 8.8 – 56 Nm.

smartARS 2 pro, smartARS 3 pro (without fuse monitoring module)
1-phase

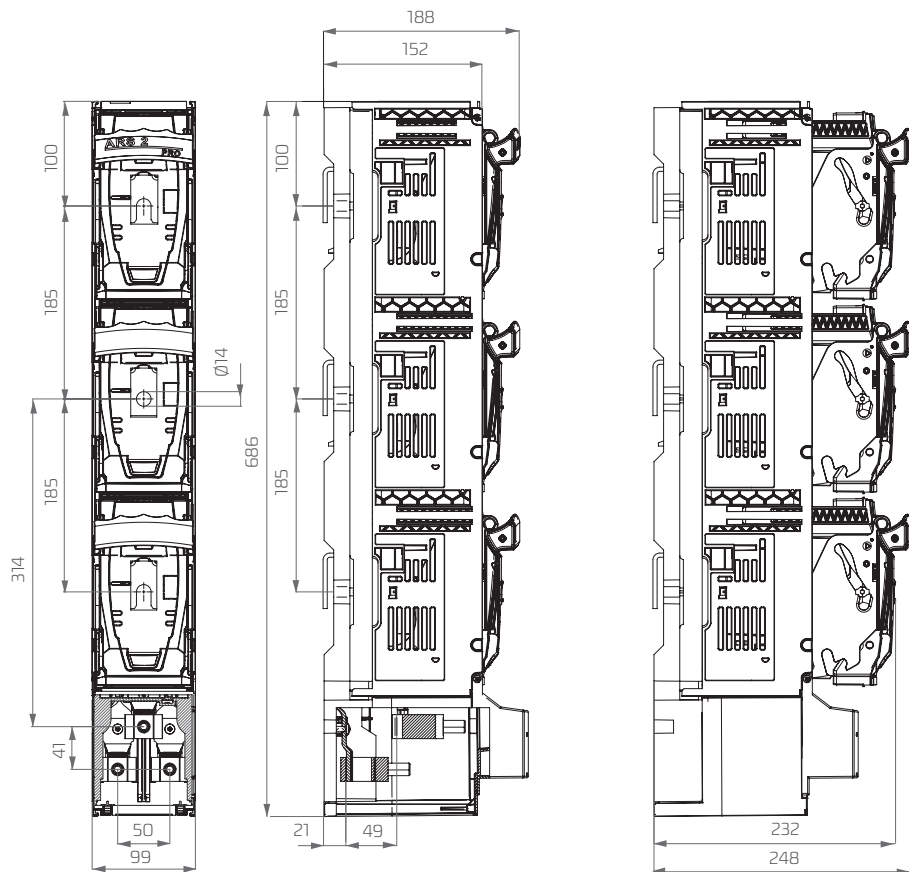

smartARS 2 pro, smartARS 3 pro (without fuse monitoring module)
RWS 600 pro, RWS 750 pro
3-phase

