

FUSE SWITCH DISCONNECTOR smartARS 2 pro (400 A, 690 V)
smartARS 3 pro (630 A, 690 V)

For installation on to 185 mm busbar system

Fuse switch disconnector's width 100 mm

3- pole switching - 3 phases simultaneously or 1-pole switching - each phase separately

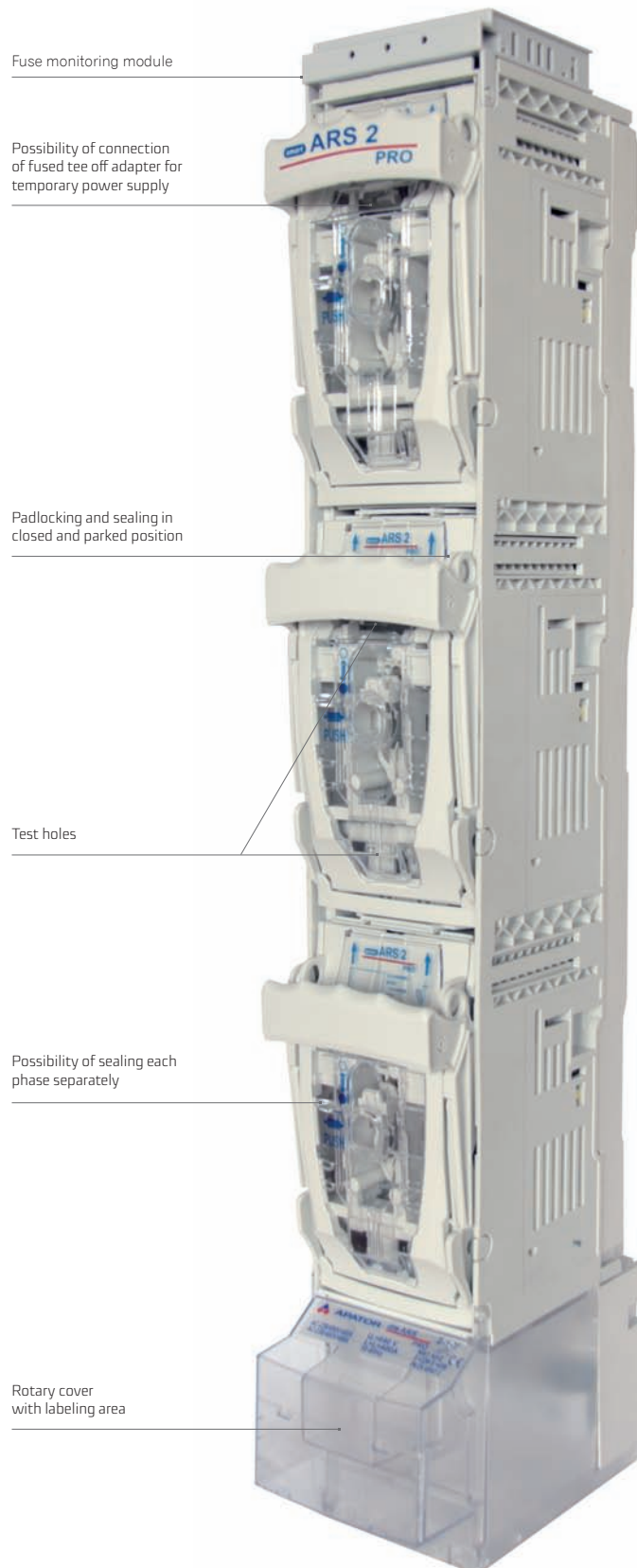

smartARS 3 pro (630 A, 690 V)



smartARS 3-1-M pro smartARS 3-6-M pro

Table 8. Technical data

Parameter	smartARS 3 pro			
Rated thermal current I_{th} with fuse links	A	630		
Rated thermal current I_{th} with solid links	A	750		
Rated voltage U_n	V	690		
Utilization category	-	AC-23B	AC-22B	AC-21B
Rated switching voltage U_e	V	400	500	690
Rated switching current I_e	A	630		
Rated short circuit making current	690 V	kA	80	
	500 V		120	
Rated short circuit withstand current	kA	100		
Rated insulation voltage U_i	V	1000		
Rated impulse withstand voltage U_{imp}	kV	12		
Rated frequency	Hz	50-60		
Mechanical durability	Number of cycles	1000		
Electrical durability		200		
IP degree of protection	-	30		
Fuse links size	-	3		









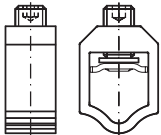
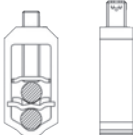
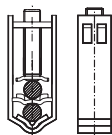

Accessories on page 54, 55

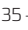
Table 9. Versions

Version	Weight	Article No.
for installation on 185 mm busbar system, ONE POLE SWITCHING - each phase independently		
smartARS 3-1-V pro cable terminals: V-terminals: V-clamps 240 mm ²	6,6 kg	63-001340-002
smartARS 3-1-M pro cable terminals: screw terminals: pressed nuts M12	6,5 kg	63-001340-004
smartARS 3-1-2V pro cable terminals: 2V-terminals: double V-clamps 240 mm ²	7,2 kg	63-001340-006
for installation on 185 mm busbar system, THREE POLE SWITCHING - all phases simultaneously		
smartARS 3-6-V pro cable terminals: V-terminals: V-clamps 240 mm ²	6,6 kg	63-001341-002
smartARS 3-6-M pro cable terminals: screw terminals: pressed nuts M12	6,5 kg	63-001341-004
smartARS 3-6-2V pro cable terminals: 2V-terminals: double V-clamps 240 mm ²	7,2 kg	63-001341-006
smartARS 2 pro version equipped with modules for fast installation using PPN technology		
for installation on 185 mm busbar system, fast installation modules equipped with screws, ONE POLE SWITCHING - each phase independently		
smartARS 3-1-V SM pro cable terminals: V-terminals: V-clamps 240 mm ²	7,0 kg	63-001340-202
smartARS 3-1-M SM pro cable terminals: screw terminals: pressed nuts M12	6,9 kg	63-001340-204
smartARS 3-1-2V SM pro cable terminals: 2V-terminals: double V-clamps 240 mm ²	7,6 kg	63-001340-206
for installation on 185 mm busbar system, fast installation modules equipped with screws, THREE POLE SWITCHING - all phases simultaneously		
smartARS 3-6-V SM pro cable terminals: V-terminals: V-clamps 240 mm ²	7,0 kg	63-001341-202
smartARS 3-6-M SM pro cable terminals: screw terminals: pressed nuts M12	6,9 kg	63-001341-204
smartARS 3-6-2V SM pro cable terminals: 2V-terminals: double V-clamps 240 mm ²	7,6 kg	63-001341-206
for installation on 185 mm busbar system, fast installation modules equipped with hooked clamps, ONE POLE SWITCHING - each phase independently		
smartARS 3-1-V SMH pro cable terminals: V-terminals: V-clamps 240 mm ²	7,2 kg	63-001340-402
smartARS 3-1-M SMH pro cable terminals: screw terminals: pressed nuts M12	7,1 kg	63-001340-404
smartARS 3-1-2V SMH pro cable terminals: 2V-terminals: double V-clamps 240 mm ²	7,8 kg	63-001340-406

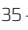
Version	Weight	Article No.
for installation on 185 mm busbar system, fast installation modules equipped with hooked clamps, THREE POLE SWITCHING - all phases simultaneously		
smartARS 3-6-V SMH pro	cable terminals: V-terminals: V-clamps 240 mm ² 7,2 kg	63-001341-402
smartARS 3-6-M SMH pro	cable terminals: screw terminals: pressed nuts M12 7,1 kg	63-001341-404
smartARS 3-6-2V SMH pro	cable terminals: 2V-terminals: double V-clamps 240 mm ² 7,8 kg	63-001341-406

Table 10. smartARS 3 pro terminal clamps

Description	smartARS 3-x-V pro	smartARS 3-x-2V pro	smartARS 3-x-2V pro	smartARS 3-x-M pro	
Clamp	V-clamp 35-300SW-B	V-clamp 2/50-300SW-B	V-clamp HS 2/50-240-C*	M-screw M12**	
Picture of clamp					
Cross – section of conductors	V-clamp for direct fixing of conductor with bare end with crosssection of				
	35 - 185 mm ² 	35 - 240 mm ² 	50 - 185 mm ² 	50 - 240 mm ² 	50 - 185 mm ² 
	35 - 240 mm ² 	35 - 300 mm ² 	50 - 240 mm ² 	50 - 300 mm ² 	50 - 240 mm ² 
Tightening torque	30 Nm	30 Nm	40 Nm	56 Nm	

For stranded conductors using cable ferrules is recommended

*) if the fuse switch disconnecter with a 2V-type clamp is to be equipped with a steel V-clamp HS 2/50-240-C, it should be included in the order

**) bars of maximum width of 40 mm and maximum thickness of 8 mm can be fixed to M type screw terminals when protective barrier between phases is installed

Apator takes responsibility for technical quality of V-terminals manufactured only by the company. Minimum tightening torque (M8 screw) for screws fixing fuse switch disconnecter to busbar system – 32 Nm, recommended tightening torque for screws and nuts with property class 8.8 – 56 Nm.

smartARS 2 pro, smartARS 3 pro (without fuse monitoring module)
1-phase

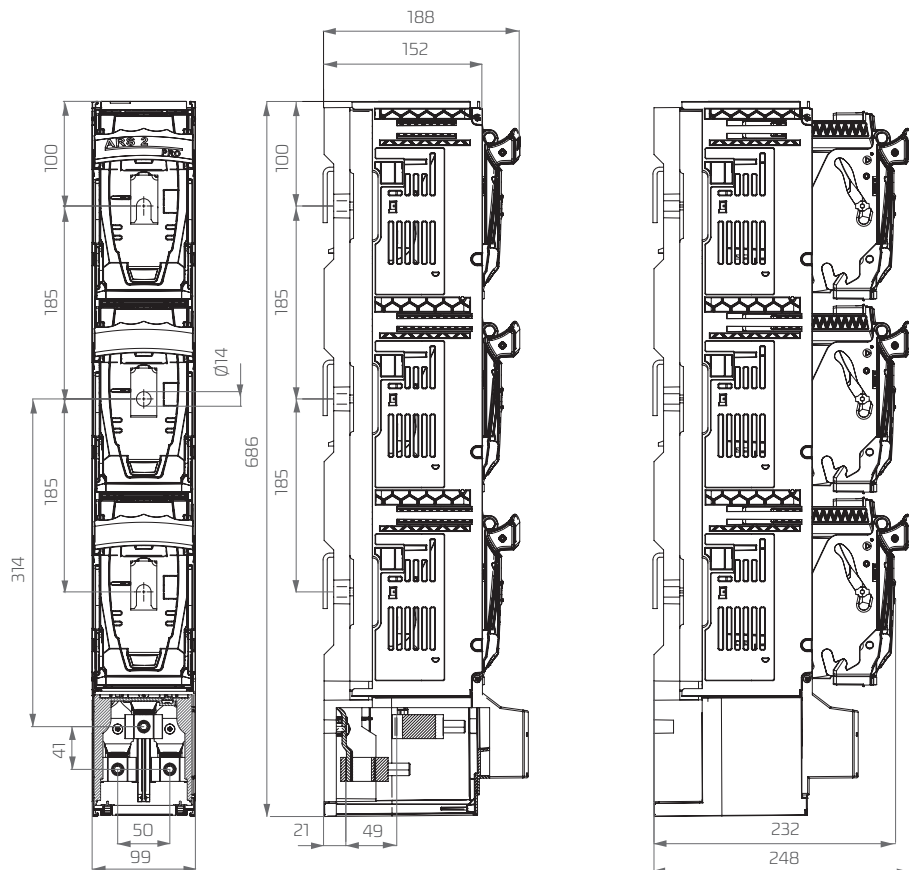

smartARS 2 pro, smartARS 3 pro (without fuse monitoring module)
RWS 600 pro, RWS 750 pro
3-phase

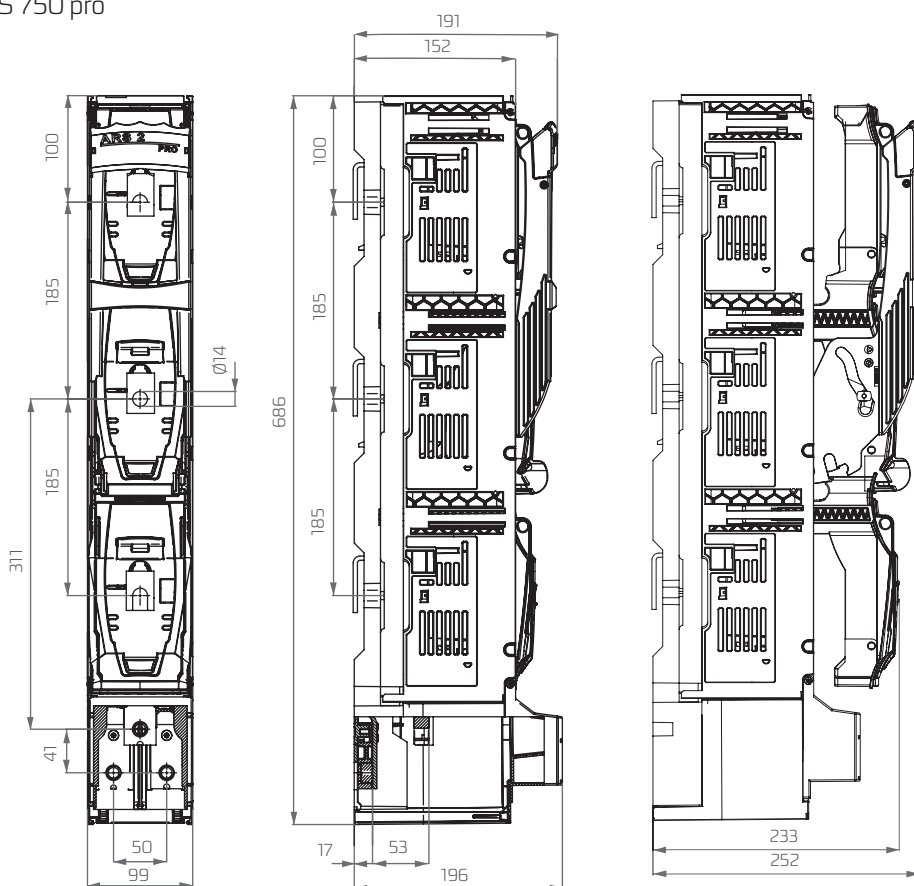

smartARS 2 pro, smartARS 3 pro with fuse monitoring module

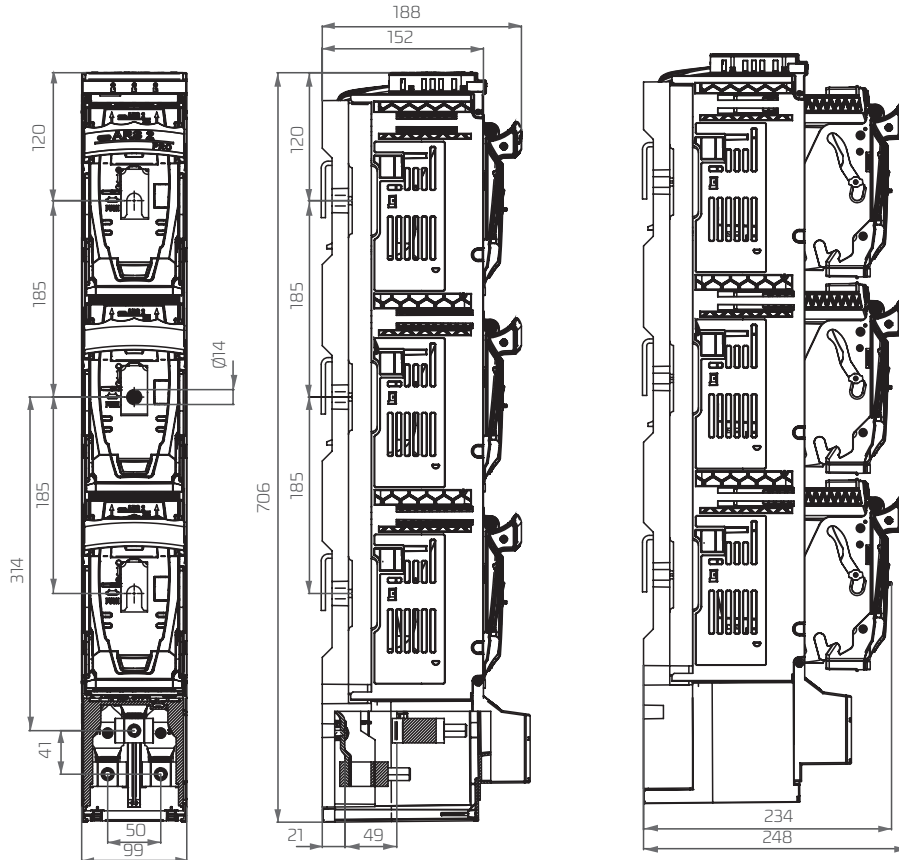

ARS OVERALL DIMENSIONS

smartARS 2 pro, smartARS 3 pro equipped with modules for fast and safe installation using PPN technology

FAST INSTALLATION MODULES EQUIPPED WITH SCREWS FAST INSTALLATION MODULES EQUIPPED WITH HOOKED CLAMPS

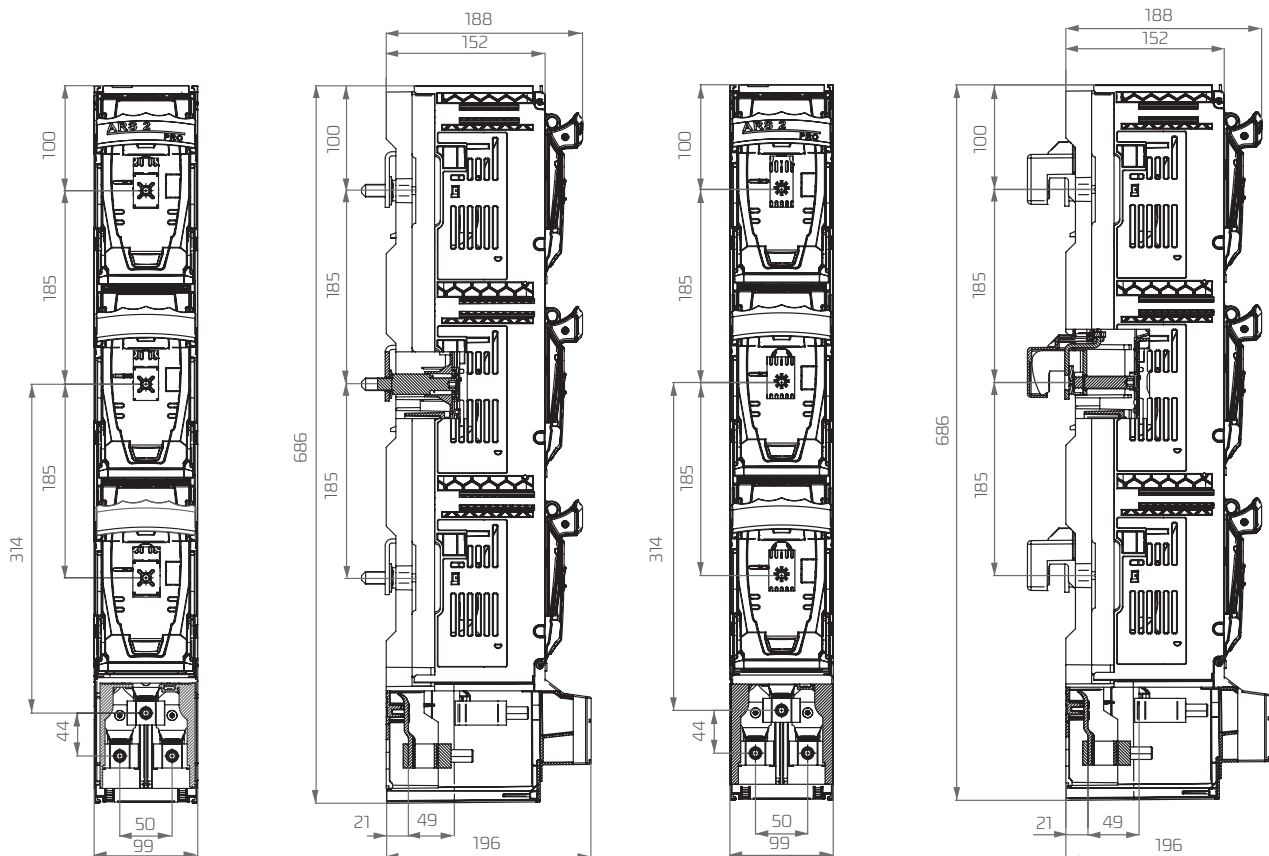

smartARS 2 pro, smartARS 3 pro with lateral busbar terminals

ARS OVERALL DIMENSIONS

