



SCULE IZOLATE LA 1000 V



Protectia totala

Sculele izolate VDE Unior asigura protectia totala, chiar si la utilizarea in apropierea sau in contact cu circuitele sub tensiune cu un potential mergand pana la 1000 Volți. Sculele sunt controlate prin teste de rezistenta la impact, la electricitate, la foc, de adeziune a izolatiei si de rezistenta la strapungere, fiecare scula fiind controlata individual.



Otel de inalta calitate

Cheile noastre, clestii, foarfecii, surubelnitele si alte scule izolate concepute pentru lucrul la instalatii electrice sau care folosesc alta forma de energie sunt fabricate din oteluri de inalta calitate, cu protectie sporita si sunt concepute pentru o utilizare simpla si sigura.



Reglementarile VDE

Izolate si controlate conform reglementarilor VDE, sculele Unior destinate lucrarilor sub tensiune satisfac exigentele normelor europene EN60900, recunoscute international



Caracteristicile surubelnitelor Unior

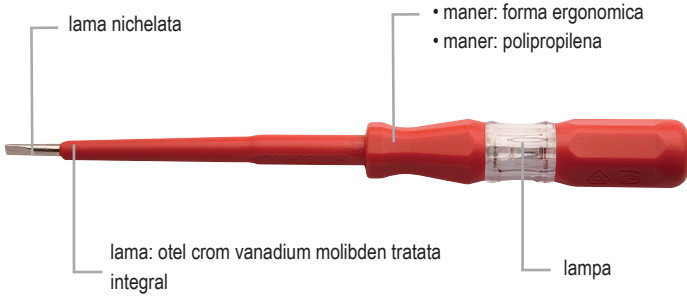
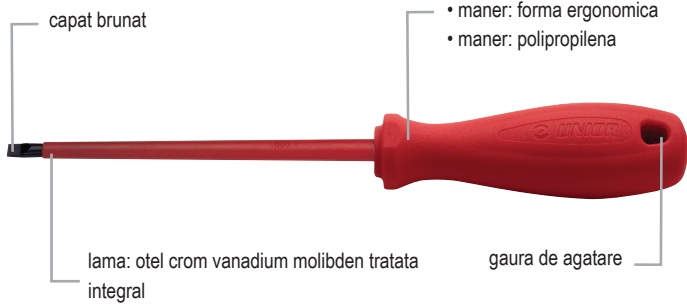
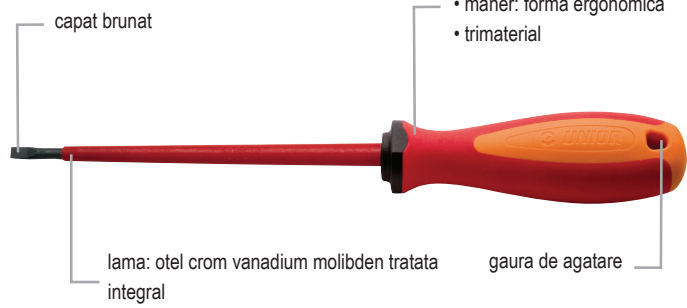

MANER ERGONOMIC

Combinatia de suprafete dure si moi imbunatateste factorul de incarcare si asigura insurubarea usoara. Manerul a fost conceput in asa fel incat are grija de sanatatea utilizatorului pentru ca reduce tensiunea in muschii mainii



Suprafata maxima de contact a mainii = valoare de cuplu superioara

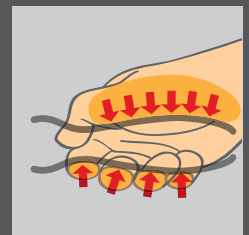
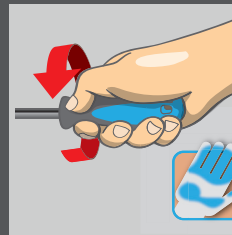

Conceptia ergonomica a manerului = protejarea mainii

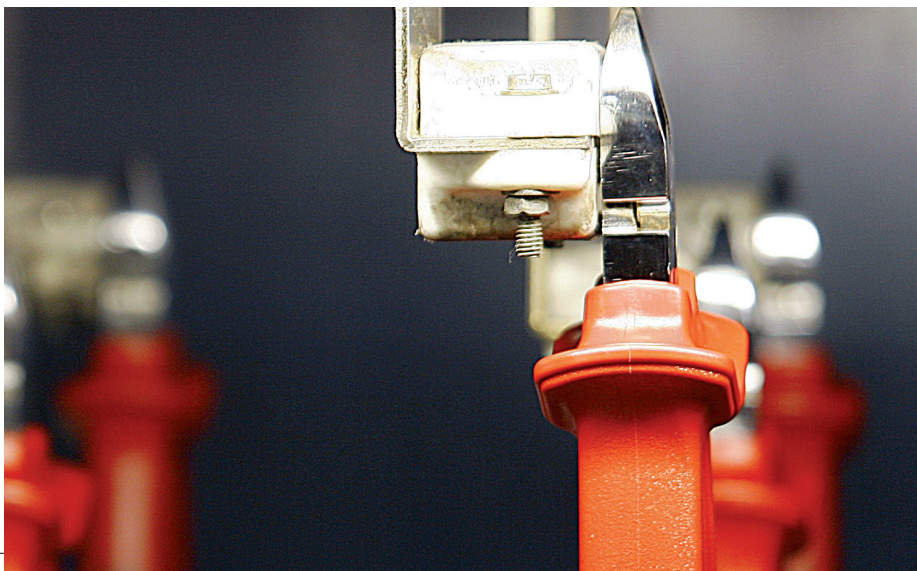

620CS6VDE TBI

Set de surubelnite izolate profil hexagonal

- lama: oțel crom vanadium molibden tratata integral
- capat brunat
- maner: forma ergonomica
- trimaterial
- gaura de agatare
- in concordanta cu standardul 60900:2004



UNIOR

617048	2.5 - 8 / 6	580	1G	1	286,42
620VDE TBI (2.5, 3, 4, 5, 6, 8)					

603CS6ATVD

Set de surubelnite izolate si tester de tensiune

- lama: oțel crom vanadium molibden tratata integral
- capat brunat
- maner: forma ergonomica
- monomaterial
- gaura de agatare
- in concordanta cu standardul ISO 8764-1,2 si 60900:2004



UNIOR

617656	6	390	1G	1	98,80
603VDE (0.5 x 3.0 x 100, 0.8 x 4.0 x 100, 1.0 x 5.5 x 125), 613VDE (PH1 x 80, PH2 x 100), 630VDE (0.5 x 3.0 x 140)					

629CS6VDE TBI

Set de surubelnite izolate cu cap tubular

- lama: oțel crom vanadium molibden tratata integral
- capat brunat
- maner: forma ergonomica
- trimaterial
- gaura de agatare
- in concordanta cu standardul 60900:2004



UNIOR

617050	5.5 - 13 / 6	865	1G	1	491,02
629VDE TBI (5.5, 6, 7, 8, 10, 13)					

621CS6VDE TBI

Set de surubelnite izolate profil TORX®

- lama: oțel crom vanadium molibden tratata integral
- capat brunat
- maner: forma ergonomica
- trimaterial
- gaura de agatare
- in concordanta cu standardul 60900:2004



UNIOR

617049	TX 10 - TX 30 / 6	511	1G	1	186,75
621VDE TBI (TX 10, TX 15, TX 20, TX 25, TX 27, TX 30)					

FR251174

Trusa scule izolate la 1000 V ELAN-17

- 1 cleste combinat, 180 mm, nr. 106
- 1 cleste cu tais lateral, 160 mm, nr. 206
- 1 cleste de telefonie, 160 mm, nr. 606
- 1 cleste de dezizolare, 160 mm, nr. 806
- 1 cleste de sertizare, 0,5-2,5 mm2, nr. 655
- 1 taietor de cablu, 160 mm, nr. 486
- 3 surubelnite, 100/4 - 125 / 5,5 - 150 / 6,5 mm, nr. 207
- 1 surubelnite PH 2, nr. 210
- 1 tester de tensiune, 65/3 mm, nr. 220
- 1 dalta de piatra, 250 x 23/13 mm
- 1 dalta, 250 x 10 mm
- 1 ciocan, 500 g
- 1 spaclu, 50 mm
- 1 castron cauciuc
- 1 cheie universala



FRIEDRICH
Sicherheitswerkzeuge



FR251174	Dimensiune	17			4589,47
330x190x280					

905VDEBI

Trusa scule izolate la 1000 V in mapa textila



UNIOR

617571	13	1958	1T	1	911,17
406/1VDEBI (180), 461/1VDEBI (160), 478/1VDEBI (160), 472/1VDEBI (160), 753VDEDP (150), 385VDE (180), 603VDE TBI (0.4 x 2.5 x 75, 0.8 x 4.0 x 100, 1.0 x 5.5 x 125), 613VDE TBI (PH1 x 80, PH2 x 100), 710P (3), 630VDE (0.5 x 3.0 x 140)					

603CS6AVDE

Set de surubelnite izolate

- lama: oțel crom vanadium molibden tratata integral
- capat brunat
- maner: forma ergonomica
- monomaterial
- gaura de agatare
- in concordanta cu standardul ISO 8764-1,2 si 60900:2004



UNIOR

617655	6	400	1G	1	101,77
603VDE (0.4 x 2.5 x 75, 0.5 x 3.0 x 100, 0.8 x 4.0 x 100, 1.0 x 5.5 x 125), 613VDE (PH1 x 80, PH2 x 100)					

906VDEBI

Trusa scule izolate la 1000 V in mapa textila



UNIOR

617573	6	911	1T	1	339,98
461/1VDEBI (160), 406/1VDEBI (180), 603VDE TBI (0.4 x 2.5 x 75, 0.8 x 4.0 x 100), 613VDE TBI (PH2 x 100), 630VDE (0.5 x 3.0 x 140)					