



# SCULE IZOLATE LA 1000 V



## Protectia totala

Sculele izolate VDE Unior asigura protectia totala, chiar si la utilizarea in apropierea sau in contact cu circuitele sub tensiune cu un potential mergand pana la 1000 Volți. Sculele sunt controlate prin teste de rezistenta la impact, la electricitate, la foc, de adeziune a izolatiei si de rezistenta la strapungere, fiecare scula fiind controlata individual.



## Otel de inalta calitate

Cheile noastre, clestii, foarfecii, surubelnitele si alte scule izolate concepute pentru lucrul la instalatii electrice sau care folosesc alta forma de energie sunt fabricate din oteluri de inalta calitate, cu protectie sporita si sunt concepute pentru o utilizare simpla si sigura.



## Reglementarile VDE

Izolate si controlate conform reglementarilor VDE, sculele Unior destinate lucrarilor sub tensiune satisfac exigentele normelor europene EN60900, recunoscute international



## Caracteristicile surubelnitelor Unior

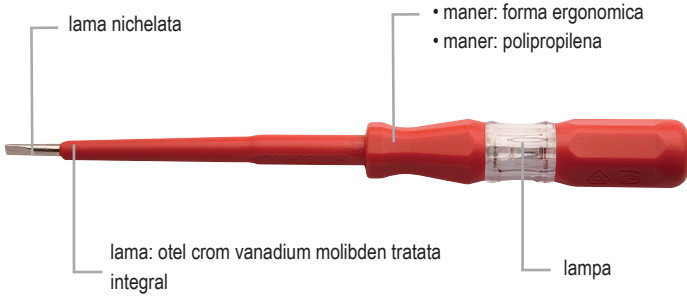
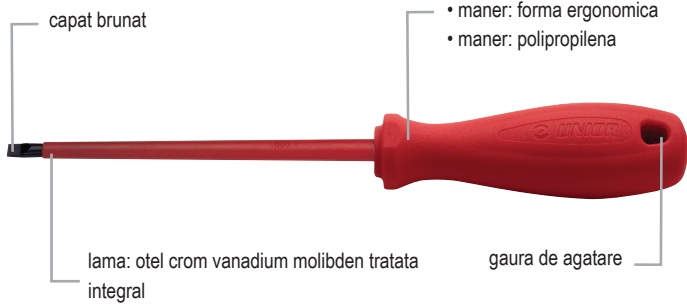
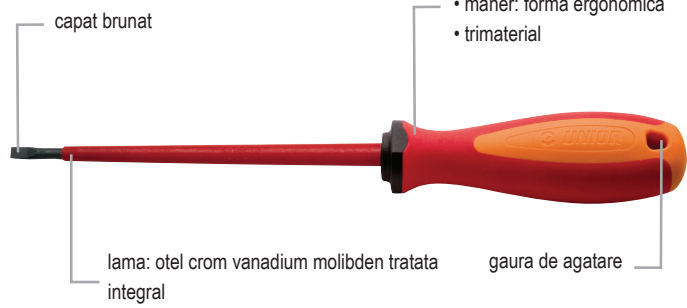

### MANER ERGONOMIC

Combinatia de suprafete dure si moi imbunatateste factorul de incarcare si asigura insurubarea usoara. Manerul a fost conceput in asa fel incat are grija de sanatatea utilizatorului pentru ca reduce tensiunea in muschii mainii



Suprafata maxima de contact a mainii = valoare de cuplu superioara

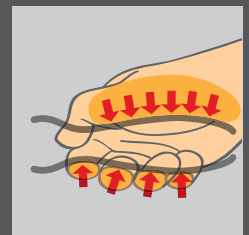
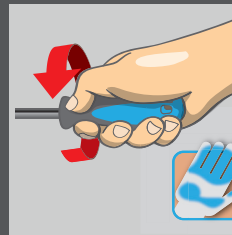

Conceptia ergonomica a manerului = protejarea mainii

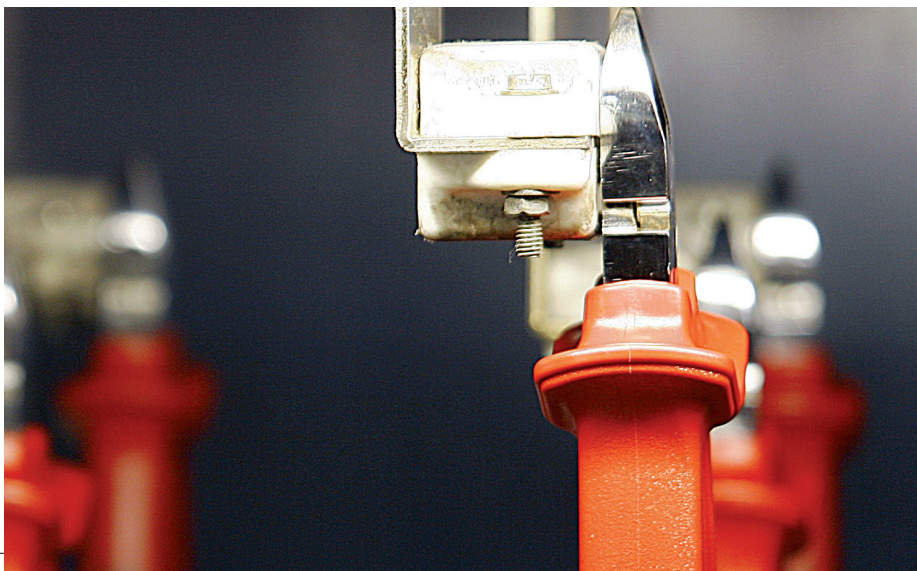

**1351VDE**

**Clema de prindere**

- material plastic

1000V  
IEC 60900



**UNIOR**

619099	L	160	77	1E	10	71,80
--------	---	-----	----	----	----	-------

**1352VDE**

**Clema de prindere**

- material plastic

1000V  
IEC 60900



**UNIOR**

619100	L	140	54	1E	10	33,81
--------	---	-----	----	----	----	-------

**FR414**

**Manusi din cauciuc natural izolate**

- certIFICATE CONFORM ISO 9003
- grad ridicat de flexibilitate
- testate individual pe toata lungimea manusii
- conform EN-60 903
- 360 mm ± 15 mm

1000V  
IEC 60900



**500V clasa 00**

FR414098	Marime	9	216,56
FR414099	Marime	10	216,56

**1000V clasa 0**

FR415095	Marime	9	253,74
FR415101	Marime	10	253,74
FR415118	Marime	11	253,74

**17kV clasa 1**

FR417099	Marime	9	458,10
FR417105	Marime	10	458,10

**603CS6AVT**

**Set de surubelnite izolate**

- lama: otel crom vanadium molibden tratata integral
- capat brunat
- maner: forma ergonomica
- trimaterial
- gaura de agatare
- in concordanta cu standardul ISO 8764-1,2 si 60900:2004

1000V  
IEC 60900



**UNIOR**

617653	6	457	1G	1	137,96
--------	---	-----	----	---	--------

- 603VDETI (0.4 x 2.5 x 75, 0.5 x 3.0 x 100, 0.8 x 4.0 x 100, 1.0 x 5.5 x 125),
- 613VDETI (PH1 x 80, PH2 x 100)

**603CS6ATVT**

**Set de surubelnite izolate si tester de tensiune**

- lama: otel crom vanadium molibden tratata integral
- capat brunat
- maner: forma ergonomica
- trimaterial
- gaura de agatare
- in concordanta cu standardul ISO 8764-1,2 si 60900:2004

1000V  
IEC 60900



**UNIOR**

617654	6	430	1G	1	129,30
--------	---	-----	----	---	--------

- 603VDETI (0.5 x 3.0 x 100, 0.8 x 4.0 x 100, 1.0 x 5.5 x 125),
- 613VDETI (PH1 x 80, PH2 x 100),
- 630VDE (0.5 x 3.0 x 140)

**603CS6VDETI**

**Set de surubelnite izolate**

- lama: otel crom vanadium molibden tratata integral
- capat brunat
- maner: forma ergonomica
- trimaterial
- gaura de agatare
- in concordanta cu standardul ISO 8764-1,2 si 60900:2004

1000V  
IEC 60900



**UNIOR**

617042	6	530	1G	1	152,36
--------	---	-----	----	---	--------

- 603VDETI (0.4 x 2.5 x 75, 0.8 x 4.0 x 100, 1.0 x 5.5 x 125, 1.2 x 6.5 x 150),
- 613VDETI (PH1 x 80, PH2 x 100)

**603CS6VDE**

**Set de surubelnite izolate**

- lama: otel crom vanadium molibden tratata integral
- capat brunat
- maner: forma ergonomica
- monomaterial
- gaura de agatare
- in concordanta cu standardul ISO 8764-1,2 si 60900:2004

1000V  
IEC 60900



**UNIOR**

617044	6	485	1G	1	111,79
--------	---	-----	----	---	--------

- 603VDE (0.4 x 2.5 x 75, 0.8 x 4.0 x 100, 1.0 x 5.5 x 125, 1.2 x 6.5 x 150),
- 613VDE (PH1 x 80, PH2 x 100)

**603CS6TVDE**

**Set de surubelnite izolate si tester de tensiune**

- lama: otel crom vanadium molibden tratata integral
- capat brunat
- maner: forma ergonomica
- monomaterial
- gaura de agatare
- in concordanta cu standardul ISO 8764-1,2 si 60900:2004

1000V  
IEC 60900



**UNIOR**

617045	6	460	1G	1	108,77
--------	---	-----	----	---	--------

- 603VDE (0.8 x 4.0 x 100, 1.0 x 5.5 x 125, 1.2 x 6.5 x 150),
- 613VDE (PH1 x 80, PH2 x 100),
- 630VDE (0.5 x 3.0 x 140)

**603CS6TVDETI**

**Set de surubelnite izolate si tester de tensiune**

- lama: otel crom vanadium molibden tratata integral
- capat brunat
- maner: forma ergonomica
- trimaterial
- gaura de agatare
- in concordanta cu standardul ISO 8764-1,2 si 60900:2004

1000V  
IEC 60900



**UNIOR**

617043	6	505	1G	1	143,75
--------	---	-----	----	---	--------

- 603VDETI (0.8 x 4.0 x 100, 1.0 x 5.5 x 125, 1.2 x 6.5 x 150),
- 613VDETI (PH1 x 80, PH2 x 100),
- 630VDE (0.5 x 3.0 x 140)