

# IS 3180

## Great performers for industry and business.

### 100% surveillance over an area of up to 500 m<sup>2</sup>.

These sensors are the perfect choice when it comes to protecting industrial and business premises and making them secure. It is important to have far-sighted guards that instantly respond to any movement. The IS 3180 is made for the job. The IP54 rating reliably protects its inner values: featuring top-calibre components such as two precision modular pyro sensors and a multi-lens, it watches over almost every last inch of areas measuring a good 500 m<sup>2</sup>. The concealed installation sensor that combines everything that's important to electrical fitters and security personnel.



  
infrared  
sensor 180°

  
4 - 8m  
or 8 - 20m

**2000w**  
max.

  
DALI

  
KNX

  
LiveLink

  
IP54 / IP20

  
1,8 - 2,5m

  
2 - 1000 lux

  
5 sec - 15 min

**TEACH**  
mode

  
energy  
saving

**5 JAHRE**  
GARANTIE  
manufacturer's  
warranty



**IS 3180**

<b>Surface-mounted</b> . . . . .	<b>square (65x95x95 mm)</b>
EAN COM1 . . . . .	4007841 009113
EAN PF . . . . .	4007841 010508
EAN KNX . . . . .	4007841 058135
EAN DALI . . . . .	4007841 010553
EAN DALI-2 . . . . .	4007841 057350
EAN LiveLink . . . . .	4007841 049409
<b>Concealed</b> . . . . .	<b>square (78x94x94 mm)</b>
EAN COM1 . . . . .	4007841 055721
EAN PF . . . . .	4007841 055769
EAN KNX . . . . .	4007841 058142
EAN DALI . . . . .	4007841 055738
EAN DALI-2 . . . . .	4007841 057367
EAN LiveLink . . . . .	4007841 055752

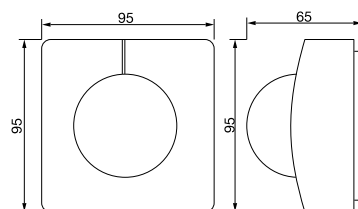

Surface-mounted, square  
For further designs, see page 56

**You will find information on the interfaces from page 52 onwards.**

Type . . . . .	Motion detector
Dimensions (H x W x D) . . . . .	95 x 95 x 65 mm
Sensor type . . . . .	Passive infrared
Where to use . . . . .	Indoors and outdoors
Installation . . . . .	Wall, corner
Mounting height . . . . .	1.8 - 2.5m
Recommended mounting height . . . . .	2m
Angle of coverage . . . . .	180° with 90° angle of aperture
Capability of masking out individual segments . . . . .	Yes
Reach . . . . .	Basic setting 1: 8–20m tangential; temperature-stabilised
	Basic setting 2: max. 4-8m, temperature-stabilised
	+ precision adjustment by re-positioning the lens and using shrouds
Sensor system . . . . .	7 detection levels, 448 switching zones
Twilight setting . . . . .	2 - 1000lx
Teach function for twilight setting . . . . .	Yes
Manual override . . . . .	Selectable, 4 h
IP rating . . . . .	Concealed: IP20 / surface-mounted: IP54
Temperature range . . . . .	-20 to +50°C

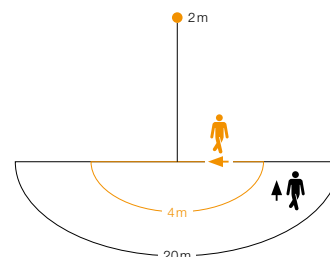

IS 3180 detection zone (20 m lens)  
Possible mounting height: 1.8 - 2.5 m  
Orange: radial  
Black: tangential

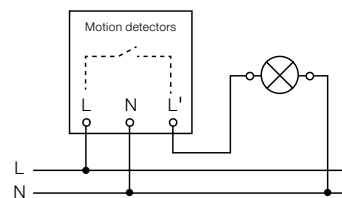

Also suitable for parallel operating mode.  
Intrinsic-light detection.

Further circuit diagrams starting on page 52

**Optional accessories**

EAN corner wall mount, white . . . . .	4007841 035174
EAN corner wall mount, black . . . . .	4007841 648015
EAN black trim, surface-mounted, square. . . . .	4007841 056711
EAN black trim, concealed, square . . . . .	4007841 056728
EAN User remote control RC5 . . . . .	4007841 592806
EAN Service remote control RC8 . . . . .	4007841 559410
EAN Remote control Smart Remote . . . . .	4007841 009151

Refer to the 'Accessories' section for further information.



Surface-mounted,  
square



Concealed,  
square

UV-resistant plastic



Large terminal compartment



Optional corner wall mount available



Optional remote controls refer to page 298

