

Single US

The ideal sensor for small corridors.

Simple tasks demand simple answers. This is demonstrated by our Single US 180° ultrasonic sensor. Correctly aligned, it detects any movement in corridors and passages of up to 10 metres in length – even if they take place behind objects. Movements in adjacent rooms, however, are not detected. This means the sensor only switches light on when it's really needed.

CONTROL
PRO
SYSTEM



ultrasonic sensor 180°



3x10m

2000w
max.

DIM
1-10V



LiveLink



2,5 - 3,5m



10 - 1000 lux

TEACH
mode



IQ-mode



energy saving

5 JAHRE
GARANTIE

manufacturer's warranty

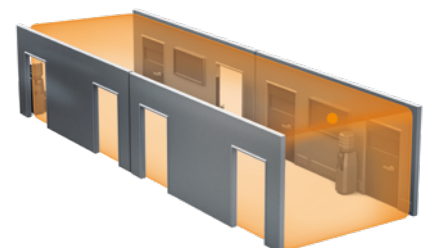

EAN Single US, COM1	4007841 007966
EAN Single US, COM2	4007841 007973
EAN Single US DALI-2	4007841 057503
EAN Single US, DIM	4007841 007980
EAN Single US, KNX	4007841 059507
EAN Single US, LiveLink	4007841 008437

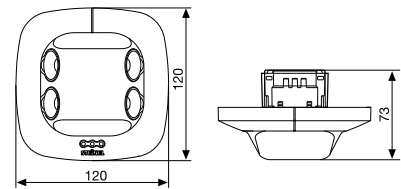

You will find information on the interfaces as well as wiring diagrams from page 142 onwards.

Type	Presence detector
Dimensions (H x W x D)	120 x 120 x 73 mm
Power supply	220-240 V, 50 / 60 Hz
Sensor type	Ultrasonic 40 kHz
Where to use	Indoors
Installation	Ceiling
Mounting height	2.50 - 3.50 m
recommended mounting height	2.80m
Angle of coverage	Corridor, one direction
Reach	3x10m
Parallel-connected configurations	Yes
User-friendly setting	Teach-In (with optional remote control RC8)
Twilight setting	10 - 1000 lx
Twilight setting DIM	100 - 1000 lx, ∞/daylight
IP rating	IP20
Temperature range	-25 to +55°C
Enclosure	UV-resistant plastic, paintable

Optional accessories

EAN User remote control RC5	4007841 592806
EAN Service remote control RC8	4007841 559410
EAN Remote control Smart Remote	4007841 009151
EAN surface-mounting adapter, AP Box	4007841 000363
EAN guard cage	4007841 003036
EAN ceiling box Ø68 mm	4007841 052812

Refer to the 'Accessories' section for further information.

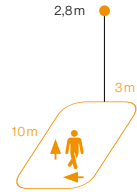

Single US detection zone
Possible mounting height: 2.5 - 3.5 m
Orange: radial and tangential

Wiring diagrams from page 142

Optional remote controls refer to page 300



For optional surface-mounted adapters, refer to page 300



Optional guard cage refer to page 300

