

Dual US

**Watches over the entire corridor.
And can see around corners.**

Switching light on and off with maximum precision in long passageways and corridors. Because all objects can be clearly detected. Thanks to ultrasonic technology, that's not a problem for the Dual US. Installed at a height of 2.5–3.5 metres, the presence detector identifies even the smallest of movements – no matter which walking direction they come from - in a detection zone of 3x20m. But only there: the sensor reliably masks out persons in adjacent rooms. That makes it the perfect corridor sensor for office and admin buildings.

CONTROL
PRO
SYSTEM



ultrasonic
sensor 360°

3x20m

2000w
max.

DIM
1 - 10V

KNX



2,5 - 3,5m

10 - 1000 lux

TEACH
mode

iQ
IQ-mode

energy
saving

5 JAHRE
GARANTIE
manufacturer's
warranty



| | |
|-----------------------|----------------|
| EAN Dual US, COM1 | 4007841 007843 |
| EAN Dual US, COM2 | 4007841 007850 |
| EAN Dual US, DALI-2 | 4007841 057466 |
| EAN Dual US, DIM | 4007841 007867 |
| EAN Dual US, KNX | 4007841 059491 |
| EAN Dual US, LiveLink | 4007841 008420 |

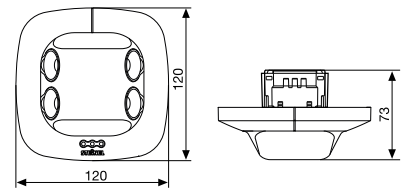

You will find information on the interfaces as well as wiring diagrams from page 142 onwards.

| | |
|-----------------------------------|---|
| Type | Presence detector |
| Dimensions (H x W x D) | 120 x 120 x 73 mm |
| Power supply | 220–240 V, 50 / 60 Hz |
| Sensor type | Ultrasonic 40 kHz |
| Where to use | Indoors |
| Installation | Ceiling |
| Mounting height: | 2.50 - 3.50 m |
| recommended mounting height: | 2.80 m |
| Angle of coverage | Corridor, both directions |
| Reach | max. 10 x 3 m in each direction |
| Parallel-connected configurations | Yes |
| User-friendly setting | Teach-In (with optional remote control RC8) |
| Twilight setting | 10–1000 lx |
| Twilight setting DIM | 100–1000 lx, ∞/daylight |
| IP rating | IP20 |
| Temperature range | -25 to +55°C |
| Enclosure | UV-resistant plastic, paintable |

Optional accessories

| | |
|--------------------------------------|----------------|
| EAN User remote control RC5 | 4007841 592806 |
| EAN Service remote control RC8 | 4007841 559410 |
| EAN Remote control Smart Remote | 4007841 009151 |
| EAN surface-mounting adapter, AP Box | 4007841 000363 |
| EAN guard cage | 4007841 003036 |
| EAN Ceiling box Ø68 mm | 4007841 052812 |

Refer to the 'Accessories' section for further information.

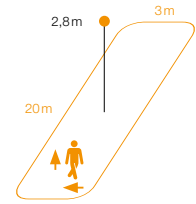

Dual US detection zone
Possible mounting height: 2.5 - 3.5 m
Orange: radial and tangential

Wiring diagrams from page 142

Optional remote controls refer to page 300



For optional surface-mounted adapters, refer to page 300



Optional guard cage refer to page 300

