

Dual HF

**A corridor sensor that points the way.
Both in technology and design.**

The Dual HF corridor sensor works with high-frequency technology that's particularly advanced. The system is fitted with 2 sensors, with each covering one corridor direction. Both of them together cover a good 20 metres in walking direction - for complete and reliable detection without blind spots. Tangential reach is deliberately limited to corridor width so as to avoid detecting movements behind closed doors, for instance.

CONTROL
PRO
SYSTEM



high frequency
sensor 360°



max. 20x3m

2000w

max.

DIM

1-10 V



2 channels



LiveLink



2,5-3,5m

iQ

iQ mode

TEACH

mode



energy
saving

5 JAHRE
GARANTIE

manufacturer's
warranty

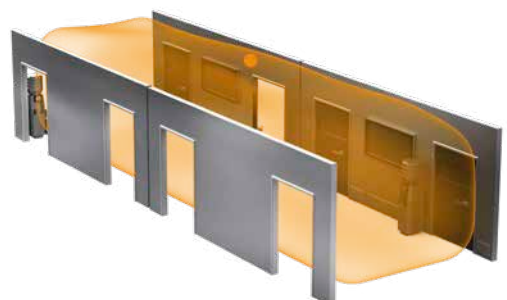

EAN Dual HF, COM1	4007841 002978
EAN Dual HF, COM1,, surface-mounted	4007841 590703
EAN Dual HF, DALI	4007841 003005
EAN Dual HF, DALI-2	4007841 057459
EAN Dual HF, DIM	4007841 002985
EAN Dual HF, KNX	4007841 059477
EAN Dual HF, LiveLink	4007841 009700

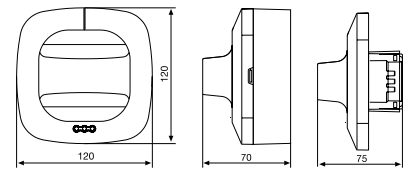

You will find information on the interfaces as well as wiring diagrams from page 142 onwards.

Type	Presence detector
Dimensions (H x W x D), concealed	120 x 120 x 75 mm
Dimensions (H x W x D), surface-mounted	120 x 120 x 70 mm
Sensor type	High frequency
Where to use	Indoors
Installation	Ceiling, corridor
Mounting height	2.5 - 3.5m
Recommended mounting height	2.8m
Angle of coverage	Corridor, both directions
	also through glass, wood and stud walls
Reach	max. 10 x 3 m in each direction,
	electronically and infinitely variable
Sensor system	5.8 GHz high frequency (transmitter output < 1 mW)
Parallel-connected configurations	Master/master, master/slave
User-friendly setting	Teach-In (with optional remote control RC8)
Twilight setting	10 - 1000 lx, ∞/daylight
Twilight setting DIM	100 - 1000 lx, ∞/daylight
IP rating	IP20
IP rating with AP Box (from accessories)	IP54
Temperature range	-25 to +55°C
Enclosure	UV-resistant, paintable

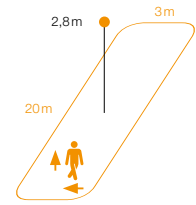

Dual HF detection zone
Possible mounting height: 2.5 - 3.5 m
Orange: radial and tangential

Wiring diagrams from page 142

Optional accessories

EAN User remote control RC5	4007841 592806
EAN Service remote control RC8	4007841 559410
EAN Remote control Smart Remote	4007841 009151
EAN surface-mounting adapter, Control PRO, surface-mounted Box	4007841 000363
EAN ceiling adapter for suspended ceilings	4007841 006600
EAN guard cage	4007841 003036
EAN Ceiling box Ø68 mm	4007841 052812

Refer to the 'Accessories' section for further information.



Surface-mounted version (AP)

Optional remote controls refer to page 300



For optional surface-mounted adapter (IP54, KNX), refer to page 300



Optional guard cage refer to page 300



HF ceiling adapter for installation on suspended ceilings

