

TK-COMBI SOCKETS

- IEC 60309, EN 60309, VDE 0623
- Protection degree IP44

TK-Combi Socket Quick-Connect

- Screwless terminals
- With terminals, with wiring (ready wired for installation)
- 109-QC with fuse base 5 x 20 mm
- With integrated domestic socket 16A/230V ~ (system F - German earthing System)
- Protection degree IP44

Accessories: see page 73

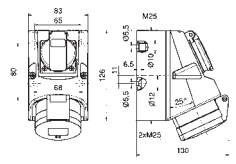

Fig.: Type 1010

1 MB 122

230V 50-60 Hz		400V 50-60 Hz		9 Stück	
2P+E Ampere	3P+E Polzahl	4pol 5pol 9h 9h	4pol 5pol 6h 6h	Stück	Stück
16	5		109-QC	10	
16	5		1010-QC	10	

TK-Combi Socket

- With terminals, without wiring
- With integrated domestic socket 16A/230V ~ (system F - German earthing System)
- Protection degree IP44

¹⁾ In the case of wiring using only one supply cable, use fuse base type 1862

Accessories: see page 73

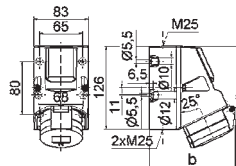

Fig.: Type 108

1 MB 17

230V 50-60 Hz		400V 50-60 Hz		9 Stück	
2P+E Ampere	3P+E Polzahl	4pol 5pol 9h 9h	4pol 5pol 6h 6h	Stück	Stück
16	4	1012		10	400
16	5		107	10	410

	16A 4p 5p	32A 4p 5p
a	154 155	156 157
b	127 130	130 136

32 ¹⁾	5		108	10	465
------------------	---	--	------------	----	-----

TK-Combi Socket

- With terminals, with wiring (ready wired for installation)
- With integrated domestic socket 16A/230V ~ (system F - German earthing System)
- Protection degree IP44

Accessories: see page 73

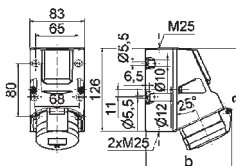

Fig.: Type 1010

1 MB 17

230V 50-60 Hz		400V 50-60 Hz		9 Stück	
2P+E Ampere	3P+E Polzahl	4pol 5pol 9h 9h	4pol 5pol 6h 6h	Stück	Stück
16	4	1013		10	420
16	5			10	460

	16A 4p 5p	32A 4p 5p
a	154 155	156 157
b	127 130	130 136

16	5			10	460
----	---	--	--	----	-----

TK-Combi Socket

- With terminals, with wiring (ready wired for installation)
- With fuse base 5 x 20 mm DIN 41671
- With integrated domestic socket 16A/230V ~ (system F - German earthing System)
- Protection degree IP44

²⁾ 2x fuse bases

Accessories: see page 73

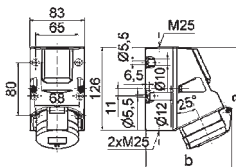

Fig.: Type 1011

1 MB 17

230V 50-60 Hz		400V 50-60 Hz		9 Stück	
2P+E Ampere	3P+E Polzahl	4pol 5pol 9h 9h	4pol 5pol 6h 6h	Stück	Stück
16	5		109	10	500
32 ²⁾	4	1020		10	515
32	5		1011	10	510

	16A 4p 5p	32A 4p 5p
a	154 155	156 157
b	127 130	130 136

32 ²⁾	5			10	510
------------------	---	--	--	----	-----

TK-Combi Socket

- Belgian/French system
- With terminals, with wiring (ready wired for installation)
- With fuse base 5 x 20 mm DIN 41671
- With integrated domestic socket 16A/230V ~ (system F - German earthing System)
- Protection degree IP44

²⁾ 2x fuse bases

Accessories: see page 73

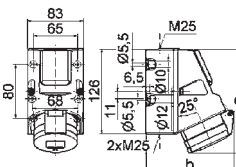

Fig.: Type 1018

1 MB 17

230V 50-60 Hz		400V 50-60 Hz		9 Stück	
2P+E Ampere	3P+E Polzahl	4pol 5pol 9h 9h	4pol 5pol 6h 6h	Stück	Stück
16 ²⁾	4	1017		10	450
16	5		1015	10	500

	16A 4p 5p	32A 4p 5p
a	154 155	156 157
b	127 130	130 136

32 ²⁾	4	1019		10	515
32	5		1018	10	510