

ELECTRIC POWER DISTRIBUTION

ETI provides high-quality solutions for the protection of low and high-voltage electrical installations in the field of electric power distribution. We supply a wide range of high-voltage fuse-links of the type VV, low voltage power circuit breakers ETIBREAK, distribution cabinets KVS, medium voltage surge arresters ETISURGE and ceramic as well as polymeric insulators. The products are internationally certified and carry several quality marks.

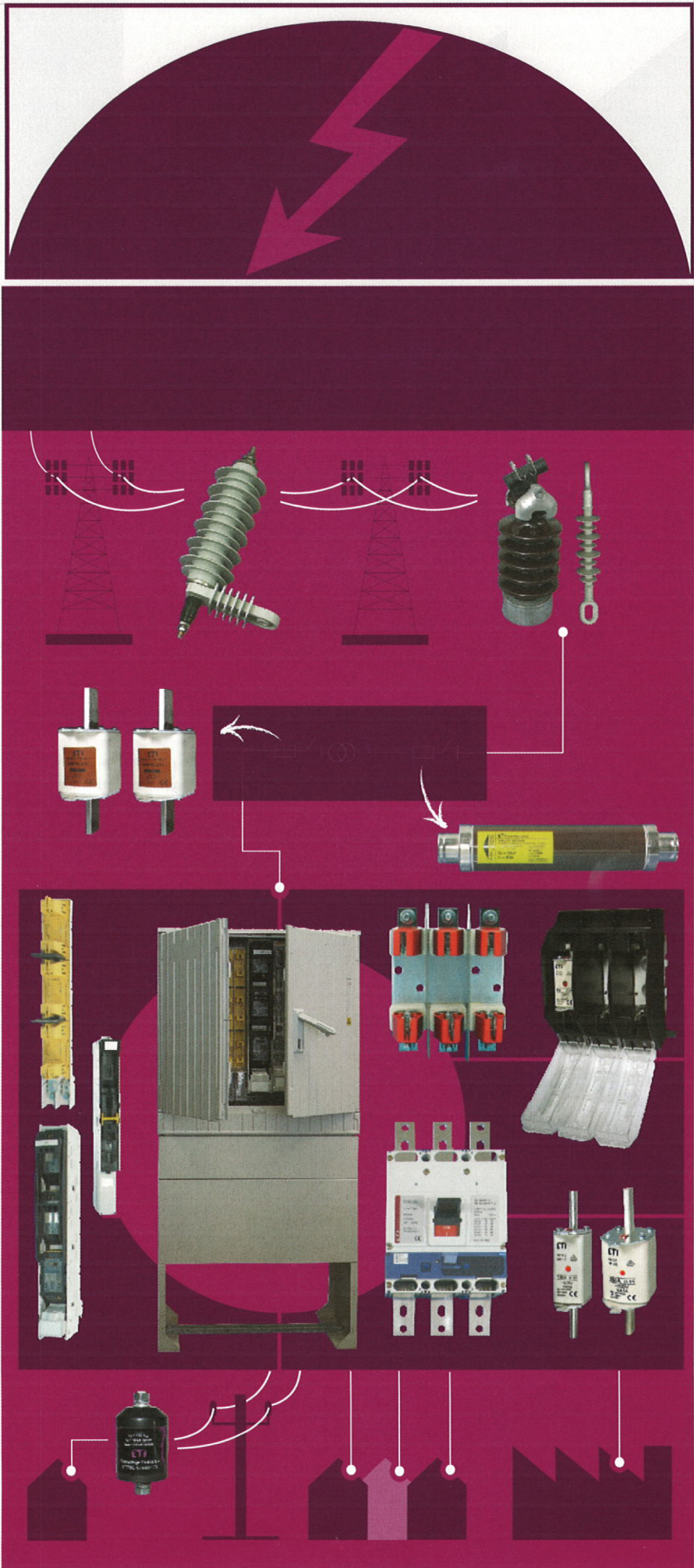

Low voltage moulded case circuit breakers with residual current protection

Main features and advantages

Breaking capacities as on MCCBs

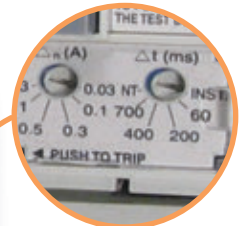

Adjustable residual current tripping thresholds between 30mA and 3A. Adjustable time delay for residual current protection between 60ms and 700ms including INST (instantaneous) and NT (No Trip).



Type A: Tripping is ensured for residual sinusoidal AC in the presence of residual pulsating DC.



Voltage Presence LED Indicator and Trip Indicator (the yellow button pops up to indicate tripping due to residual current)



Test Button (to test the residual current detection and tripping system)



Dielectric test device plug (to allow dielectric testing with the EB2R closed – ON)



Adjustable overload protection I_R can be set between 63% and 100% of I_n

Accessories for EB2, ED2 125

	Code No	Poles	Packaging [pcs]
Slide mechanical interlock, MS 125 3P, MO or RO assembly not possible	004671172	3p	1
Slide mechanical interlock, MS 125 4P, MO or RO assembly not possible	004671173	4p	1
Link mechanical interlock, MLR 125 right, MO or RO assembly possible	004671174	3p, 4p	1
Link mechanical interlock, MLL 125 left 3p, MO or RO assembly possible	004671175	3p	1
Link mechanical interlock, MLL 125 left 4p, MO or RO assembly possible	004671176	4p	1
Wire mechanical interlock, MW 125, mechanism, MO or RO assembly possible	004671177	3p, 4p	1

Link mechanical configuration; MLR_right + MLL_left

Wire mechanical configuration; 2x MW_mech. + MW_cable

Accessories for EB2, ED2 125

	Code No	Poles	Packaging [pcs]
Handle locks, ZA2 125-250	004671180	3p, 4p	1
Terminal cover lock, PZ 125-630AF	004672400	3p, 4p	1
Terminal cover, PRS2 125/3, front	004671181	3p	1
Terminal cover, PRS2 125/4, front	004671182	4p	1
Terminal cover, PRS2-SP 125/3, cable clamps	004671183	3p	1
Terminal cover, PRS2-SP 125/4, cable clamps	004671184	4p	1
Terminal cover, PRS2-NPF 125/3, plug-in	004671473	3p	1
Terminal cover, PRS2-NPF 125/4, plug-in	004671474	4p	1
Interpol barrier, IZ2 125	004671185	3p, 4p	1
DIN rail adapter, DIN 125 & 250	004671186	3p, 4p	1

Accessories for EB2, ED2 125

	Code No	Poles	Packaging [pcs]
Fixed plug-in 3-p, NPF 125	004671451	3p	1
Fixed plug-in 4-p, NPF 125	004671452	4p	1
Plug-in Conversion 3-p, NPI 125	004671453	3p	1
Plug-in Conversion 4-p, NPI 125	004671454	4p	1
Extension terminal for fixed Plug-in 3-p, SK3 125	004671455	3p	3
Extension terminal for fixed Plug-in 4-p, SK4 125	004671456	4p	4

- basic configuration: fixed plug-in + plug-in conversion

- extension terminals is used when fixed part of plug-in is under mounting plate - not used for basic configuration

- if additional accessories are installed in MCCB, plugs and sockets (PSPSS, PSHUV and PIO) are required

Accessories for EB2, ED2 160 and EB2, ED2 250

	Code No	Poles	Packaging [pcs]
Attach busbar ZB2 250/3 Offset	004671191	3p	3
Attach busbar, ZB2 250/4 Straight	004671192	4p	3
Attach busbar, ZB2 250/3 Straight	004671325	3p	3
Solderless Terminal, SP2 250/3	004671193	3p	4
Solderless Terminal, SP2 250/4	004671194	4p	4
Rear connections, RC2 250/3S-L	004671477	3p	3
Rear connections, RC2 250/3E	004671478	3p	3
Rear connections, RC2 250/4S-L	004671479	4p	4
Rear connections, RC2 250/4E	004671480	4p	4
Busbar adapter 3p, DA-60/250/3/FE-5	001696162	3p	1
Busbar adapter 4p, DA-60/250/4/FE-5	001696163	4p	1



MLR+MLL



DIN 125, 250



PRS2



NPF



NPI

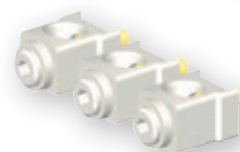

SP2



ZB2 Offset



RC2



DA-60

External accessories

IZ – Interpole barrier. Installed between MCCB terminal, which increases the distance between poles to reduce the possibility of creepage.

PRS – Terminal cover. The terminal covers are applied to the MCCB to prevent accidental contact with live parts and thereby protection against direct contact.

PRS-ZB – Terminal cover for att. Busbar. The terminal covers are applied to the MCCB to prevent accidental contact with live parts and thereby protection against direct contact. The width is different because of attach busbar.

SP – Solderless terminal

RO – Operating handle, breaker mounted. It's used when MCCB is installed in control centre/switchboard

RO_P – Operating handle, panel mounted, variable depth. This consists of an operating mechanism mounted on the breaker, an operating handle mounted on the panel door and a square shaft to connect the mechanism with the handle.

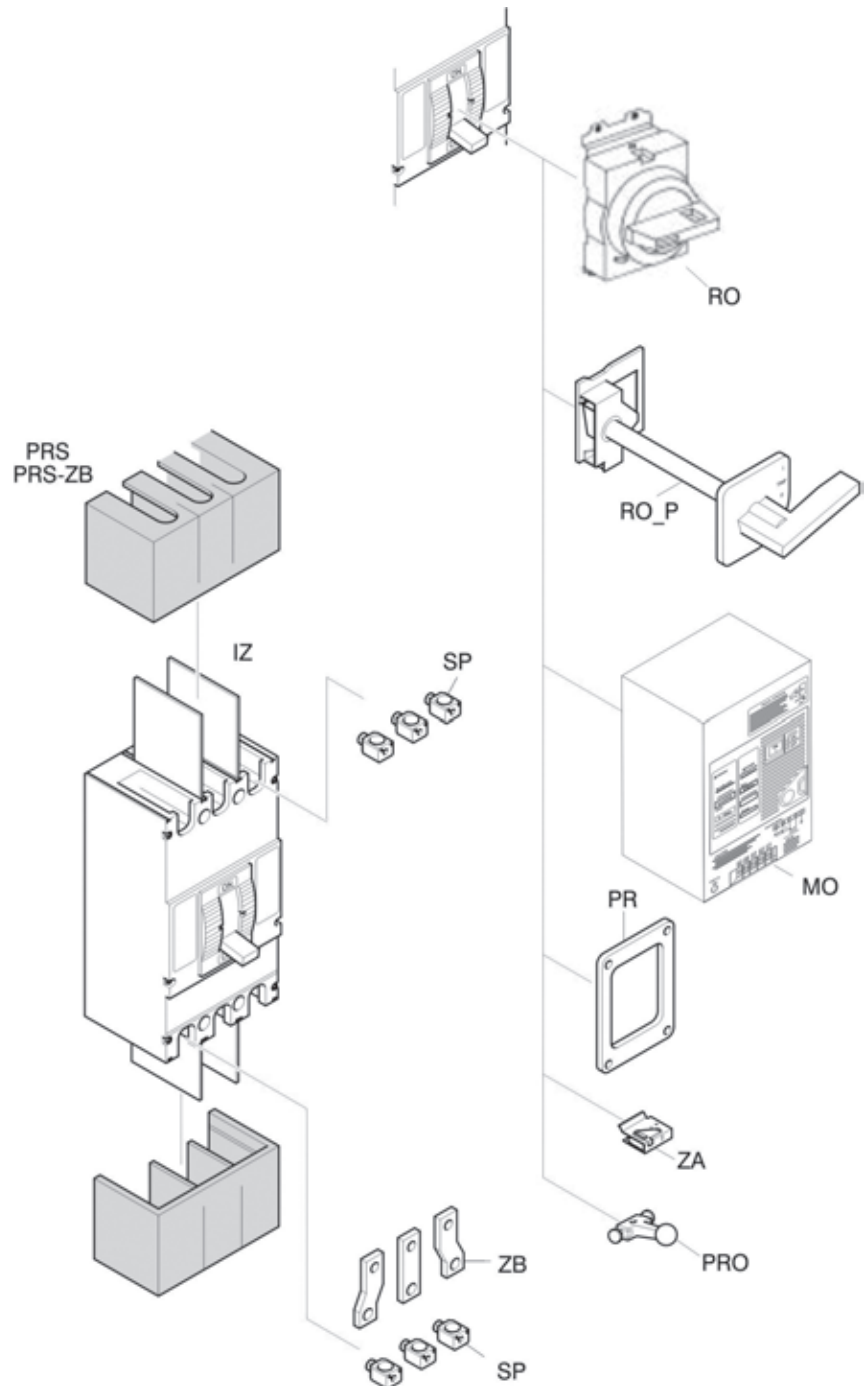

MO – Motor operator. Enabling to switch MCCB ON or OFF remotely.

PR – Door flange. Accessory for mounting on panel door.

ZA – Handle lock. Enables the MCCB to be padlocked in neither the ON or OFF position.

ZB – Attach busbar. Used for easier installation on busbar systems (widen terminals).

PRO – Handle extension. Used for easier manipulation ON/OFF at bigger MCCB's.