

FUSEHOLDERS FOR CYLINDRICAL DC FUSE-LINKS

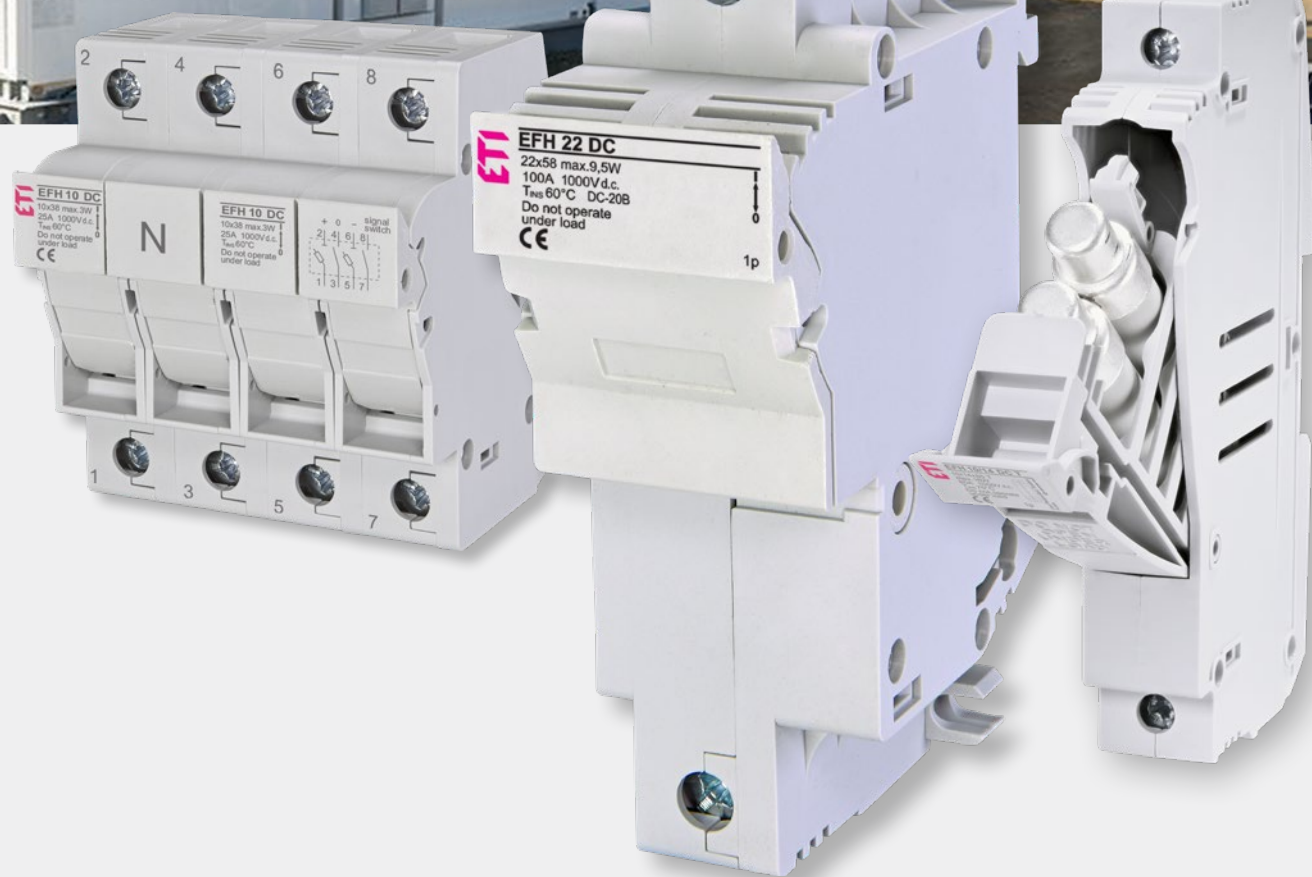

Advantages of DC fuseholder EFH

→ More space for finger to open fuse carrier



→ Compliance with IEC 60947-1, IEC 60947-3, UL 4248-1, UL 4248-19



→ Mounting on standard DIN 35 mm rail (DIN EN60715)

→ All contact surfaces are silver plated

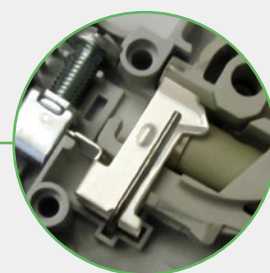

→ Complete protection against touch according to IP20

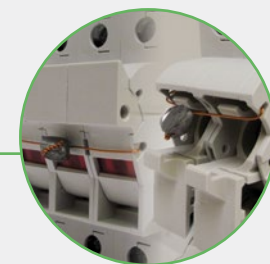

→ Possibility of sealing in ON or OFF positions

→ All plastic parts are made of material resistant to extremely high temperatures. Fuse carrier assures that a fuse-link is not in touch with a housing



→ For both sizes a **version with electronic indicator** is available. Marked with **L (LED)**, the EFH has a built-in LED diode which blinks after the fuse-link operates. Operating voltage ranges from 50V to 1000V d.c.



→ Modular design – it is possible to assemble multi-pole versions at the building site

Fuse holder EFH 10, 14, 22 1000V d.c.

General characteristics		UL file: E356295
Rated voltage	1000V d.c.	
Rated current	25A, 50A, 100A	
Utilization category	DC-20B (Do not operate under load)	
Degree of protection	IP20	
Standards	IEC 60947-1, IEC 60947-3, UL 4248-1, UL 4248-19	

EFH 10 d.c.							
Number of poles	U_e/U_i [V]	I_{max} [A]	Code No.	Max. power dissipation of the fuse-link per pole [W]	Indicator	Weight [g]	Pack. [pcs]
1p	1000	25	002540201	3	-	63	12/108
			002540211		LED	64	
2p			002540203		-	124	6/54
			002540213		LED	125	
2p+N+S*			002540204		-	257	3/27

*Only IEC certified

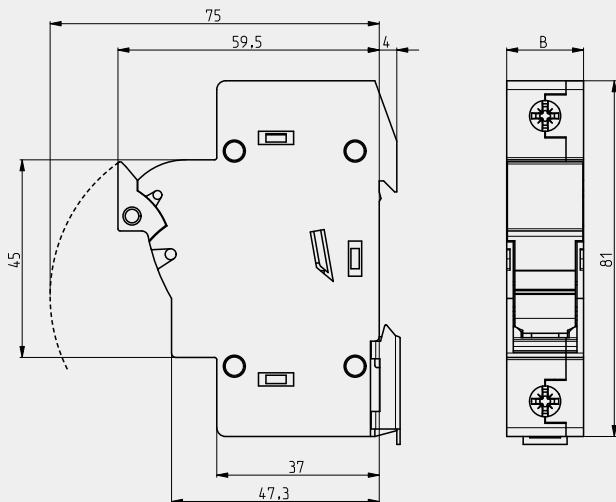

	B
1p	17,5
2p	35
2p+N+S	70



C fuse - holders