

Free-standing cable distribution cabinets

Pedestal extender

Type	Code No.	For use with	Weight [kg]	Packaging [pcs]
KVR-PE 00	001601620	KVR 00	4,60	1
KVR-PE 0	001601621	KVR 0, KVR 01	5,20	1
KVR-PE 1	001601622	KVR 1, KVR 11	6,00	1
KVR-PE 2	001601623	KVR 2, KVR 21	7,40	1

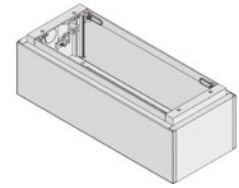

Mounting plate metal Zn for regular size (874mm) enclosure

Type	Code No.	For use with	Weight [kg]	Packaging [pcs]
KVR-MP 00	001601630	KVR 00	5,20	4
KVR-MP 0	001601631	KVR 0	6,80	4
KVR-MP 1	001601632	KVR 1	9,20	4
KVR-MP 2	001601633	KVR 2	13,00	4

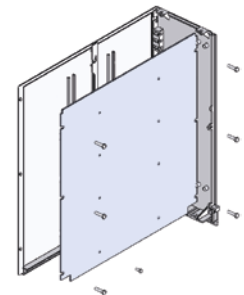

Mounting plate metal Zn for 1m size enclosure

Type	Code No.	For use with	Weight [kg]	Packaging [pcs]
KVR-MP 01	001601634	KVR 01	6,3	4
KVR-MP 11	001601635	KVR 11	8,75	4
KVR-MP 21	001601636	KVR 21	17	4
KVR-MP 2	001601633	KVR 2	13,00	4

Copper bars without pressed nuts - available upon request

Type	Dimension, for use with	Weight [kg]	Packaging [pcs]
KVR-CB 00 30x5	30x5x444, KVR 00	0,60	4
KVR-CB 00 40x5	40x5x444, KVR 00	0,78	4
KVR-CB 0 30x5	30x5x580, KVR 0, KVR 01	0,78	4
KVR-CB 0 40x5	40x5x580, KVR 0, KVR 01	1,05	4
KVR-CB 1 40x5	40x5x774, KVR 1, KVR 11	1,35	4
KVR-CB 1 40x10	40x10x774, KVR 1, KVR 11	2,70	4
KVR-CB 1 60x10	60x10x774, KVR 1, KVR 11	4,10	4
KVR-CB 2 40x5	40x5x1104, KVR 2, KVR 21	1,90	4
KVR-CB 2 40x10	40x10x1104, KVR 2, KVR 21	3,80	4
KVR-CB 2 60x10	60x10x1104, KVR 2, KVR 21	5,80	4

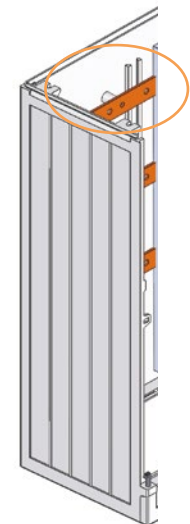

Angle bar for cable fixation

Type	Code No.	Dimension, for use with	Weight [kg]	Packaging [pcs]
KVR-FB 00	001601640	450mm, KVR 00	0,42	4
KVR-FB 0	001601641	585mm, KVR 0, KVR 01	0,58	4
KVR-FB 1	001601642	784mm, KVR 1, KVR 11	0,76	4
KVR-FB 2	001601643	1110mm, KVR 2, KVR 21	1,00	4

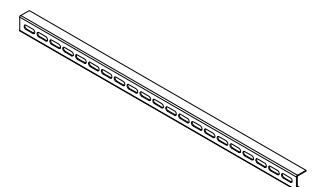

Technical data

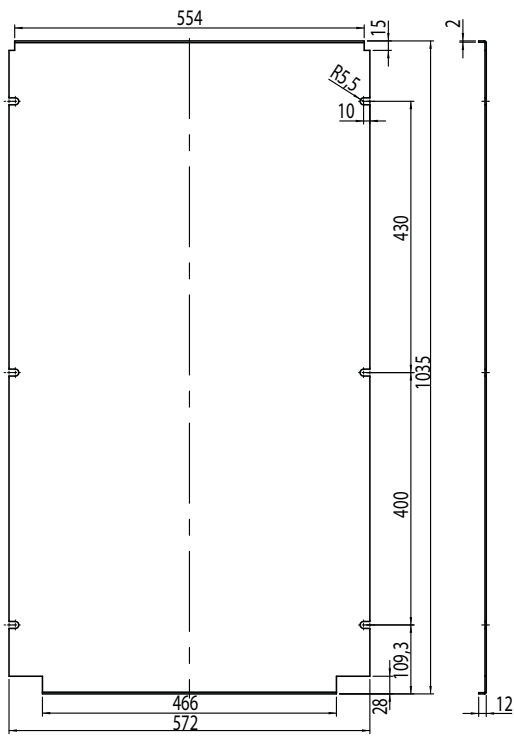

MP01

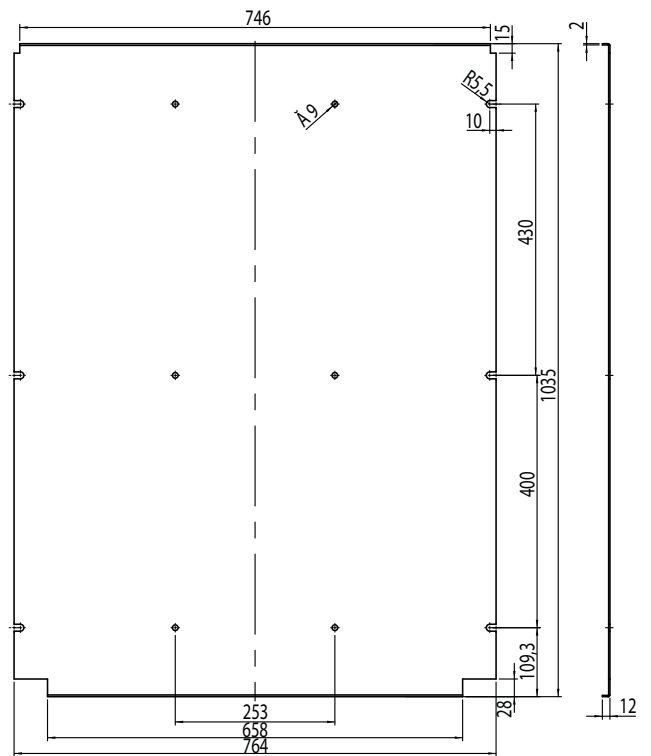

MP11

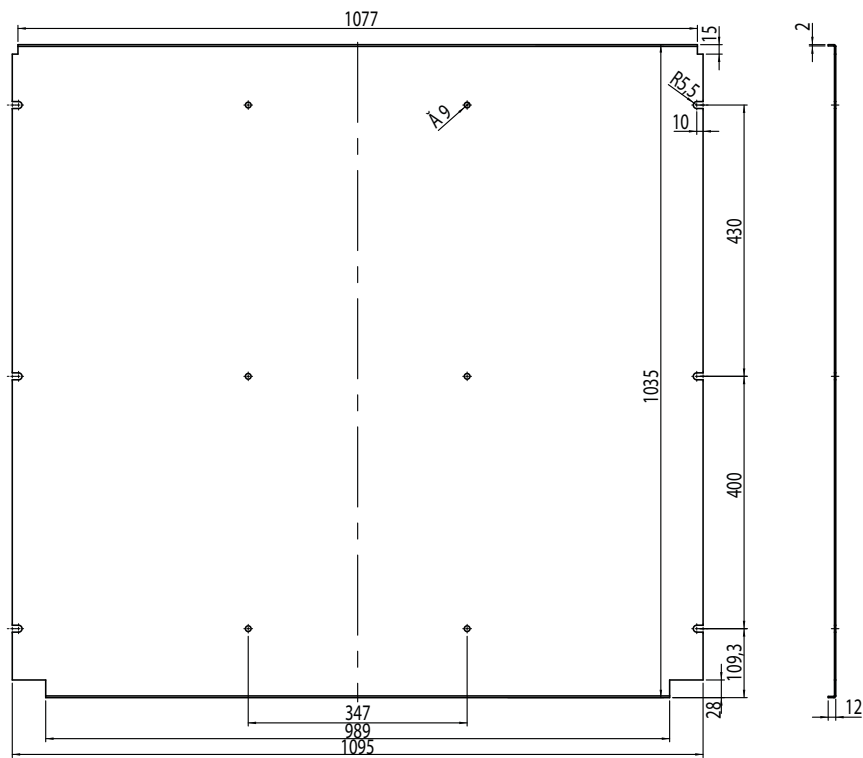

MP21